

FANTINI

OFFICINA MECCANICA AGRICOLA

46046 MEDOLE (MN) Via Brigoni 6

Tel. 0376-868202-868520 Fax 868969 Tlx 300462



SPANNOCCHIATORE PIEGHEVOLE

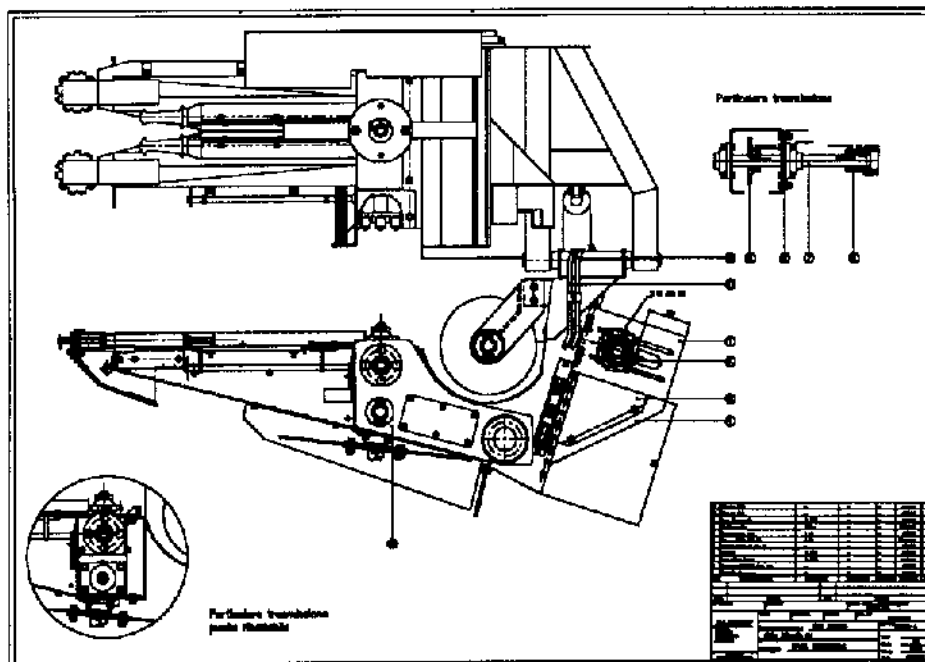

CATALOGO

TELAIO

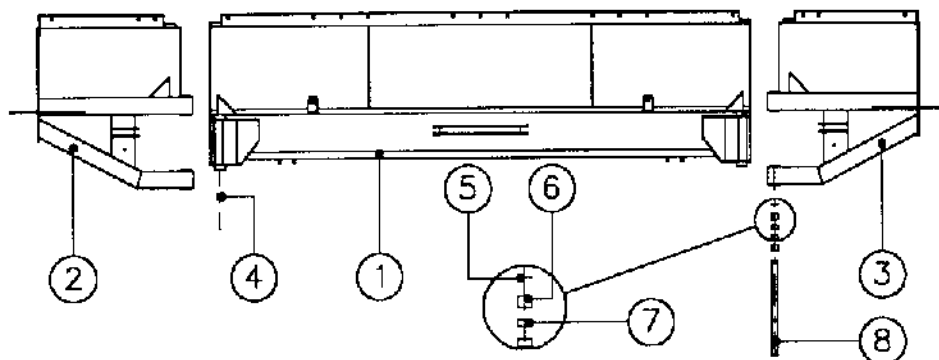

| POS. | CODICE | DESCRIZIONE |
|------|------------|---------------------------------|
| 1 | SR0020 | TELAIO CENTRALE REG. 75 |
| 1 | SR0370 | TELAIO CENTRALE REG. 80 |
| 2 | SR0349 | TELAIO SX REG. 75 |
| 2 | SR0369 | TELAIO SX REG. 80 |
| 3 | SR0020 | TELAIO DX REG. 75 |
| 3 | SR0371 | TELAIO DX REG. 80 |
| 4 | CU9206 | BOCCOLA JR 35x40x30 |
| 5 | B870238 | ANELLO ELASTICO E35 UNI 7435-75 |
| 6 | PAP3530P20 | BUSSOLA AUTOLUBRIFICANTE |
| 7 | PAP3520P20 | BUSSOLA AUTOLUBRIFICANTE |
| 8 | SR0015 | ALBERO COLLEGAMENTO TELAI |

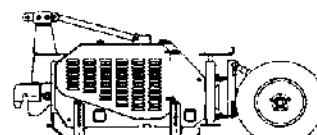
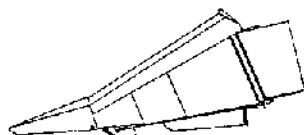

COCLEA CONVOGLIATRICE

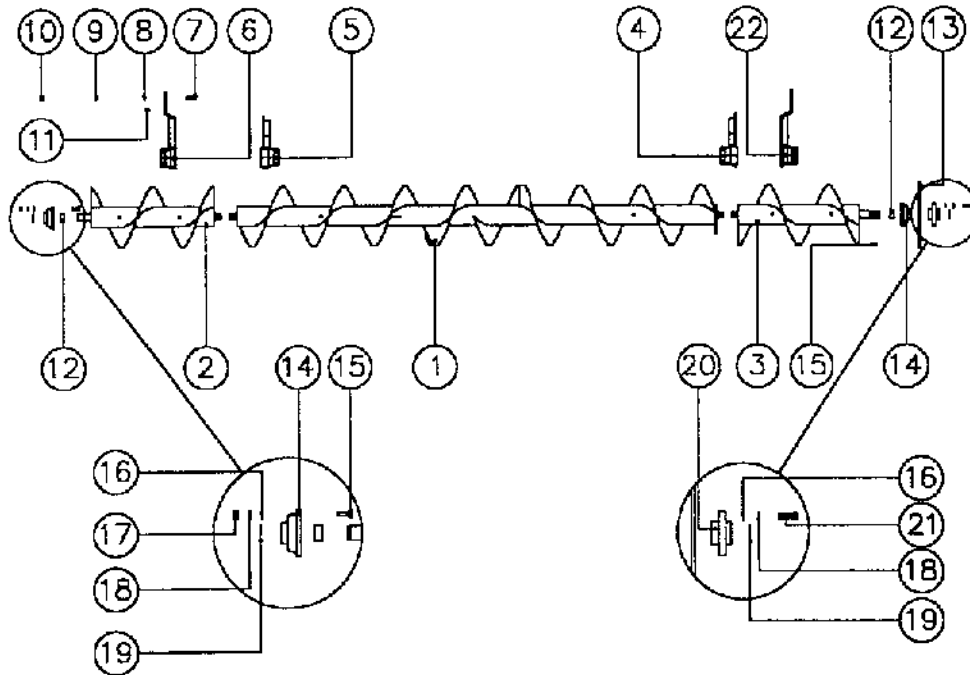

| POS. | CODICE | DESCRIZIONE |
|------|----------|--------------------------------------|
| 1 | SR0095 | COCLEA CENTRALE 6/F R.75 |
| 1 | SRSR0386 | COCLEA CENTRALE 6/F R.80 |
| 2 | SR0078 | COCLEA LATERALE DX R.75 |
| 2 | SR0390 | COCLEA LATERALE DX R.80 |
| 3 | SR0071 | COCLEA LATERALE SX R.75 |
| 3 | SR0393 | COCLEA LATERALE SX R.80 |
| 4 | SR0087 | SUPPORTO COCLEA CENTRALE SX |
| 5 | SR0315 | SUPPORTO COCLEA CENTRALE DX |
| 6 | SR0316 | SUPPORTO COCLEA RIB. DX |
| 7 | B870101 | VITE TE M16X45 UNI5739 |
| 8 | B870086 | ROSETTA PER M16 UNI6592 |
| 9 | B870010 | R.D.E. PER M16 UNI8842 |
| 10 | B870011 | DADO M16 ALTO UNI5587 |
| 11 | B91019 | SPINA ELAST. 8x25 UNI6875-71 |
| 12 | SR0345 | DISTANZIALE ESTERNO PER COCLEA |
| 13 | GS87710 | CORONA Z62ASA60 FORI FILETTATI |
| 14 | S870003 | SUPPORTO UCF208 mm40 BLOC. CON GRANO |
| 15 | B870051 | LINGUETTA 10x8x40 UNI6604 |
| 16 | B870044 | ROSETTA PER M12 UNI6593 |
| 17 | B870007 | DADO M12 ALTO UNI5587 |
| 18 | B870008 | R.D.E. PER M12 UNI8842 |
| 19 | B870052 | ANILLO ELASTICO E40 UNI7435-75 |
| 20 | GS87702 | MOZZO COCLEA |
| 21 | B900006 | VITE TE M12X45X1,25 UNI5738 |
| 22 | SR0188 | SUPPORTO COCLEA RIB. SX |

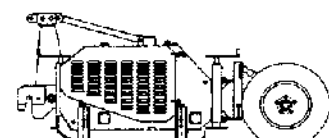
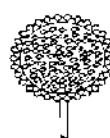
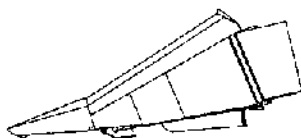

TRASMISSIONE COCLEA

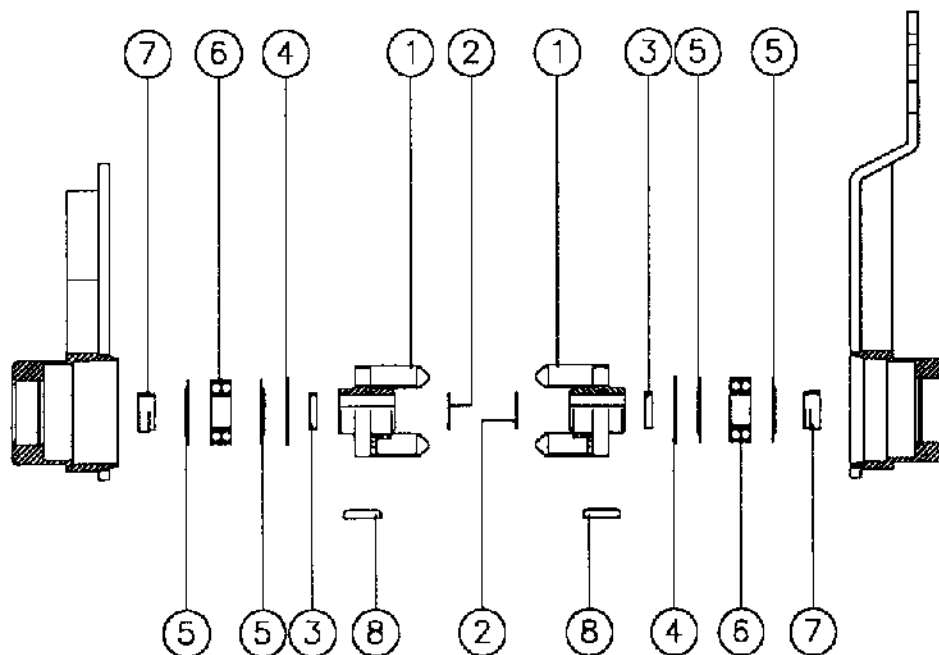

| POS. | CODICE | DESCRIZIONE |
|------|---------|--------------------------------|
| 1 | SR0105 | INNESTO COCLEA |
| 2 | B870025 | ANELLO ELASTICO E30 UNI7435-75 |
| 3 | SR0165 | DISTANZIALE PER COCLEA |
| 4 | B870116 | ANELLO ELASTICO I62 UNI7437-75 |
| 5 | B91018 | ANELLO NYLOS 2206 JV |
| 6 | CU9204 | CUSCINETTO 2206 2RS |
| 7 | SR0166 | DISTANZIALE POSTERIORE COCLEA |
| 8 | B870024 | LINGUETTA 8x7x45 |

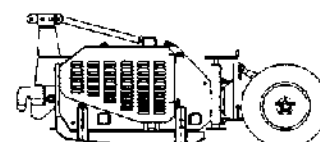

SCATOLA SENZA TRINCIASTOCCHI

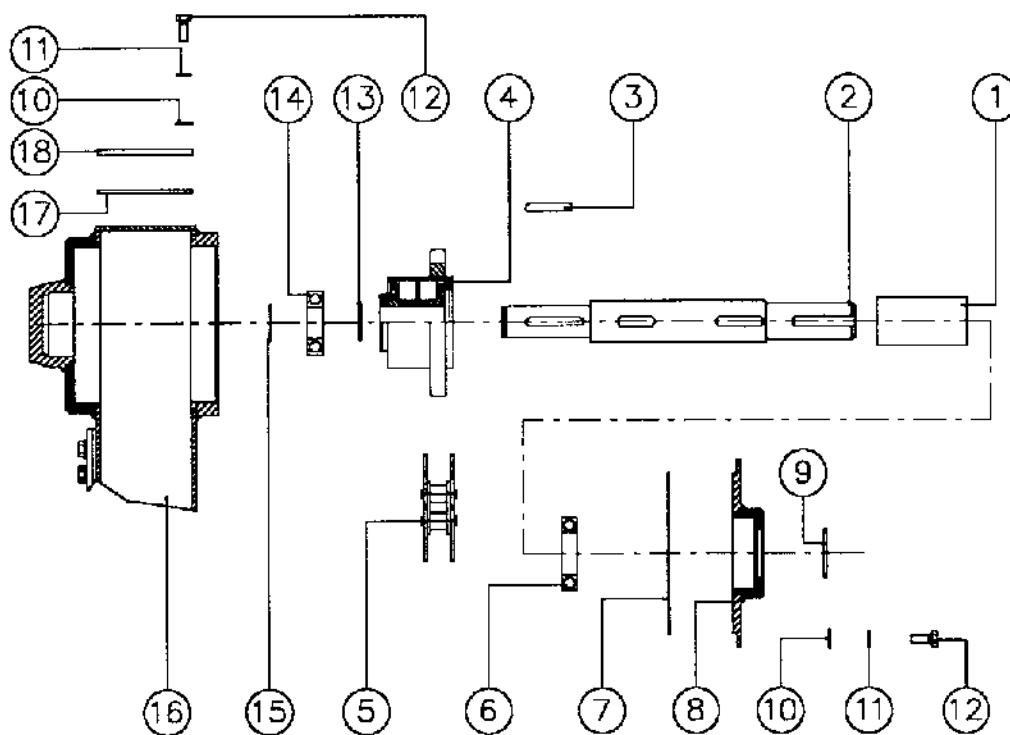

| POS. | CODICE | DESCRIZIONE |
|------|----------|--------------------------------|
| 1 | SR0117 | DISTANZIALE |
| 2 | SR0229 | ALBERO PER SCATOLA TRASM. |
| 3 | B870024 | LINGUETTA 8x7x45 |
| 4 | SR0332 | FRIZIONE Z16x1" 63 dNm |
| 5 | C92022 | CATENA ASA80 57 PASSI +GIUNTO |
| 6 | CU910002 | CUSCINETTO 6008 |
| 7 | B91012 | CORDA O.R. 1,78 LUNG. 470 mm |
| 8 | SR0069 | COPERCHIO |
| 9 | B91008 | O.R. 144 |
| 10 | B870031 | ROSETTA PER M8 UNI6592 |
| 11 | B870032 | R.D.E. PER M8 UNI8842 |
| 12 | B870048 | VITTE M8x16 UNI5739 |
| 13 | B870077 | RONDELLA DI RASAM. 30x42x0.5 |
| 14 | CU910001 | CUSCINETTO 6206 |
| 15 | B870025 | ANELLO ELASTICO E30 UNI7435-75 |
| 16 | SR0338 | SCATOLA TRASM. SALDATA DX |
| 16 | SR0016 | SCATOLA TRASM. SALDATA SX |
| 17 | SR0109 | GUARNIZIONE GOMMA MEDIA |
| 18 | SR0108 | COPERCHIO SCATOLA |

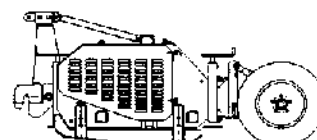

SCATOLA SENZA TRINCIASTOCCHI

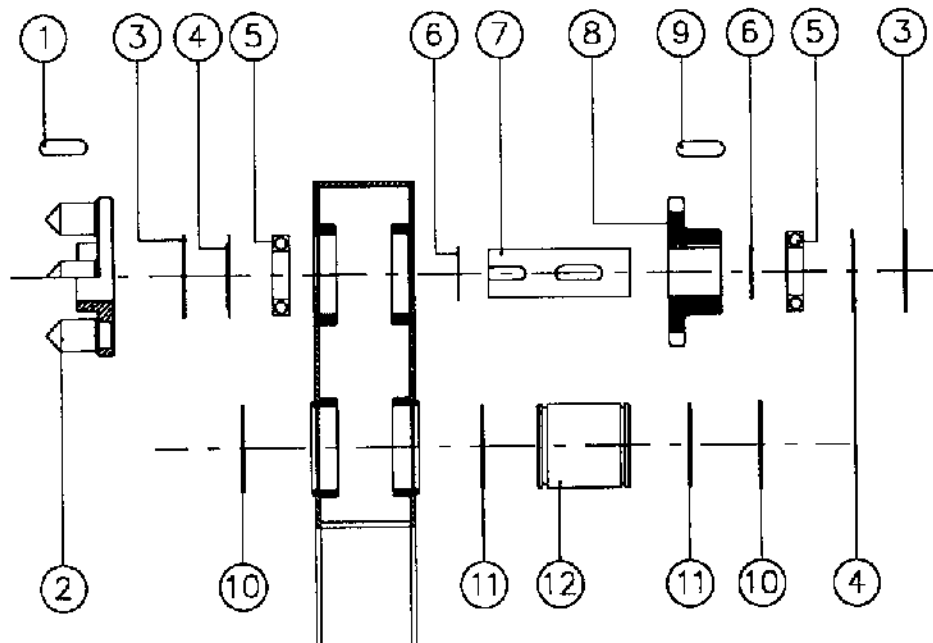

| POS. | CODICE | DESCRIZIONE |
|------|----------|--------------------------------|
| 1 | B91015 | LINGUETTA 12x8x35 UNI6604-69 |
| 2 | SR0637 | INNESTO TRASM. D=45 SX M.1993 |
| 2 | SR0638 | INNESTO TRASM. D=45 DX M.1993 |
| 3 | B870060 | ANELLO ELASTICO 175 UNI7437-75 |
| 4 | B91016 | ANELLO NILOS 6009 ZIV |
| 5 | CU870003 | CUSCINETTO 6009-2RS |
| 6 | B92118 | RONDELLA DI RASAM. 45x52x0.2 |
| 7 | SR0090 | BUSSOLA CEMENTATA |
| 8 | SR0331 | PIGNONE Z16 ASA 80 FORO 45 mm |
| 9 | B91014 | LINGUETTA 12x8x45 UNI6604-69 |
| 10 | B870087 | ANELLO ELASTICO 180 UNI7437-75 |
| 11 | B91011 | OR 176 |
| 12 | SR0129 | TUBO CON SEDI PER OR |

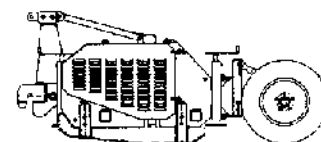
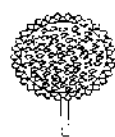

SCATOLA CON TRINCIASTOCCHI

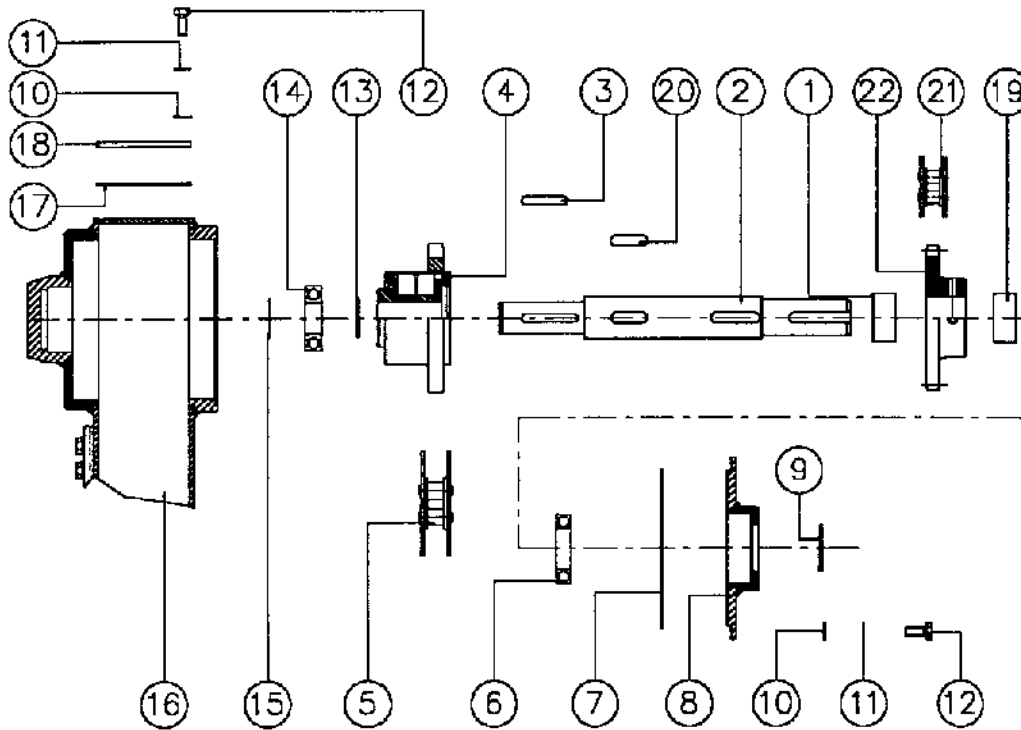

| POS. | CODICE | DESCRIZIONE |
|------|------------|--------------------------------|
| 1 | SR0335 | DISTANZIALE |
| 2 | SR0229 | ALBERO PER SCATOLA TRASM. |
| 3 | B870024 | LINGUETTA 8x7x45 |
| 4 | SR0332 | FRIZIONE Z16x1*63 dNm |
| 5 | C92022 | CATENA ASA80 57 PASSI + GIUNTO |
| 6 | CU910002 | CUSCINETTO 6008 |
| 7 | B91012 | CORDA O.R.1,78 LUNG.470 mm |
| 8 | SR0069 | COPERCHIO |
| 9 | B91008 | O.R. 144 |
| 10 | B870031 | ROSETTA PER M8 UNI 6592 |
| 11 | B870032 | R.D.E. PER M8 UNI 8842 |
| 12 | B870048 | VITE M8x16 UNI 5739 |
| 13 | B870077 | RONDELLA DI RASAM.30x42x0.5 |
| 14 | CU910001 | CUSCINETTO 6206 |
| 15 | B870025 | ANELLO ELASTICO I30 UNI7435-75 |
| 16 | SR0338 | SCATOLA TRASM. SALDATA DX |
| 16 | SR0016 | SCATOLA TRASM. SALDATA SX |
| 17 | SR0109 | GUARNIZIONE GOMMA MEDIA |
| 18 | SR0108 | COPERCHIO SCATOLA |
| 19 | SR0334 | DISTANZIALE |
| 20 | B890002 | LINGUETTA 10x8x35 |
| 21 | C92023 | CATENA ASA60 H 69 PASSI |
| 22 | P22ASA60.G | PIGNONE Z22ASA60.G |

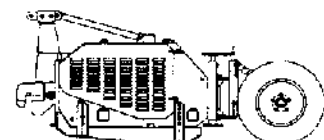

SCATOLA CON TRINCIASTOCCHI

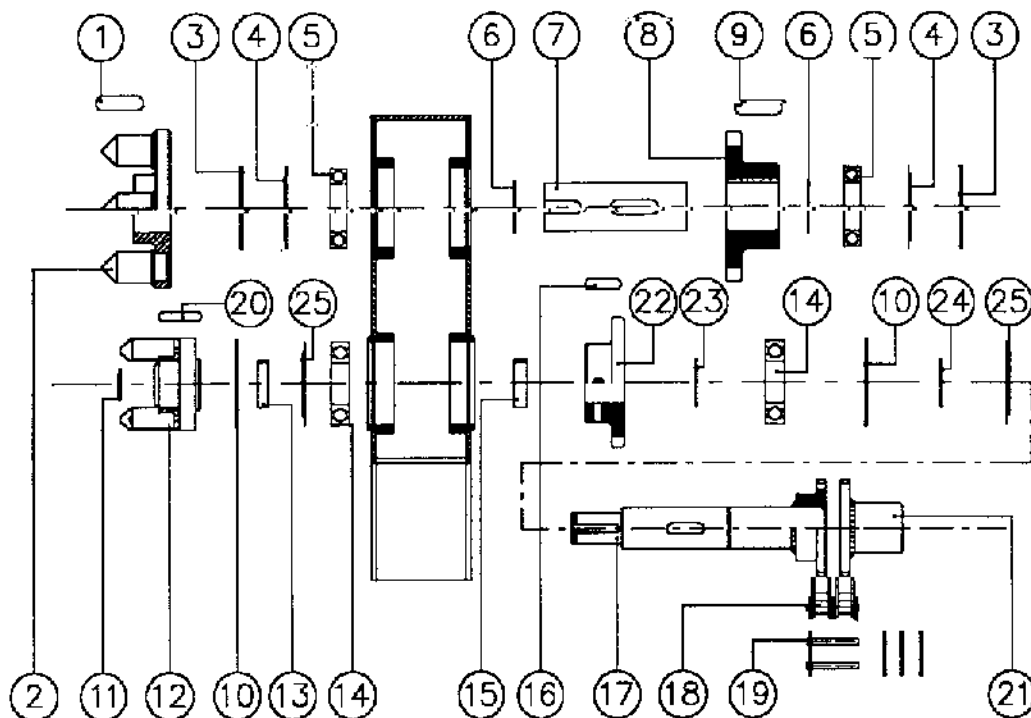

| POS. | CODICE | DESCRIZIONE |
|------|----------|-------------------------------------|
| 1 | B91015 | LINGUETTA 12x8x35 UNI 6604-69 |
| 2 | SR0638 | INNESTO TRASM. D=45 SX M. 1993 |
| 2 | SR0637 | INNESTO TRASM. D=45 DX M. 1993 |
| 3 | B870060 | ANELLO ELAST. 175 UNI 7437-75 |
| 4 | B91016 | ANELLO NILOS 6009 |
| 5 | CU870003 | CUSCINETTO 6009-2RS |
| 6 | B92118 | RONDELLA DI RASAM. 45x52x0.2 |
| 7 | SR0090 | BUSSOLA CEMENTATA |
| 8 | SR0331 | PIGNONE Z. 16 ASA 80 FORO 45mm |
| 9 | B91014 | LINGUETTA 12x8x45 UNI 6604-69 |
| 10 | B870087 | ANELLO ELAST. 180 UNI 7437-75 |
| 11 | B870025 | ANELLO ELAST. E30 UNI 7435-75 |
| 12 | SR0321 | INNESTO DX TRINCIASTOCCHI |
| 13 | SR0330 | DIST. PER SCATOLA TRINC. 10mm |
| 14 | CU9203 | CUSCINETTO 6208-2RS |
| 15 | SR0339 | DIST. PER SCATOLA TRINC. 13mm |
| 16 | B890002 | LINGUETTA 10x8x35 UNI 6604-69 |
| 17 | SR0317 | ALBERO PER SCATOLA TRINC. |
| 18 | C890007 | CATENA ASA 60 DOPPIA 13 PASSI AAAAA |

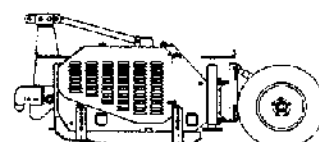
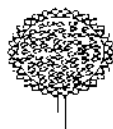

SCATOLA CONTRINCIASTOCCHI

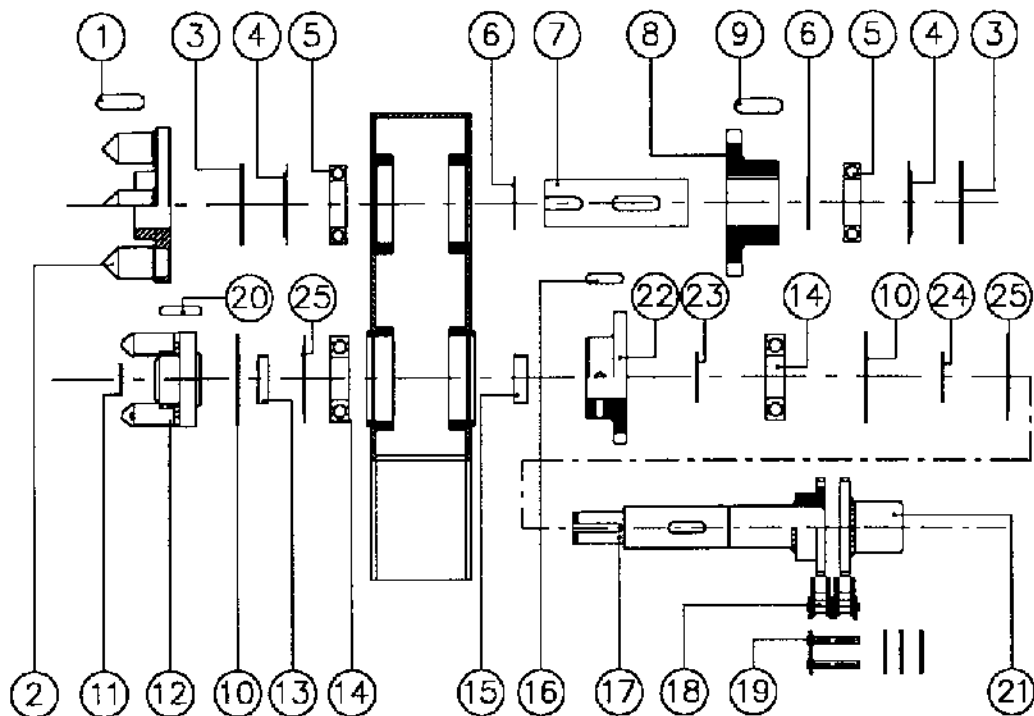

| POS. | CODICE | DESCRIZIONE |
|------|----------|------------------------------|
| 19 | C890008 | GIUNTO ASA 60 DOPPIO |
| 20 | B880004 | LINGUETTA 8x7x40 UNI 6604-69 |
| 21 | SR0319 | GIUNTO TRASMISSIONE TRINC. |
| 22 | P19ASA60 | PIGNONE Z 19 ASA 60 |
| 23 | B91007 | RONDELLA DI RASAM. 40x50x1 |
| 24 | B870052 | ANELLO ELAST.F40 UNI 7435-75 |
| 25 | B92117 | ANELLO NILOS 6208 ZJV |

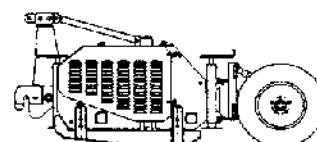
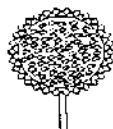

TENDITORI SCATOLA

TENDITORE CATENA TRINCIASTOCCHI

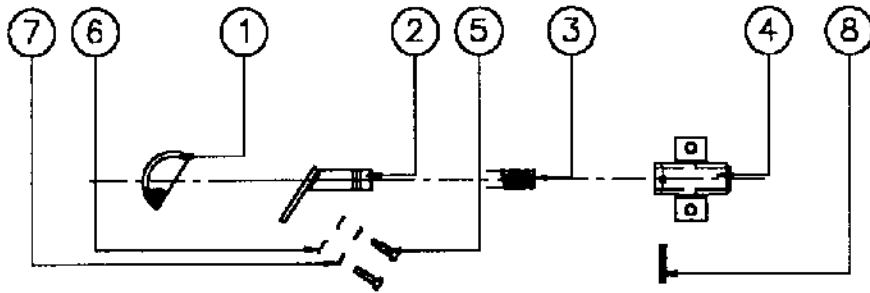

TENDITORE CATENA TRASMISSIONE

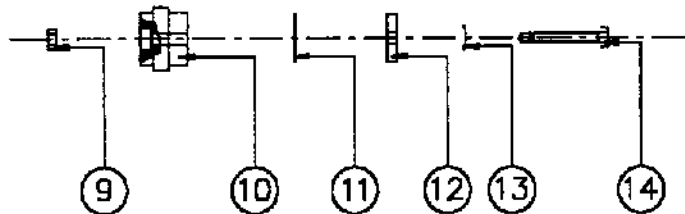

| POS. | CODICE | DESCRIZIONE |
|------|---------|-------------------------------|
| 1 | SR0524 | NYLON PER TENDITORE TR |
| 2 | SR0525 | PERNO SCORREVOLE |
| 3 | SR0527 | MOLLA PER TENDITORE TR |
| 4 | SR0526 | TUBO PER PERNO TENDITORE TR |
| 5 | B870035 | VITE M6x16 UNI 5739 |
| 6 | BZ01029 | ROSETTA PER M6 UNI 6592 |
| 7 | B870037 | R.D.E. PER M6 UNI 8842 |
| 8 | B91009 | SPINA ELAST. 6x35 UNI 6875-71 |
| 9 | B870013 | DADO M10 FLANG. TEMPRATO |
| 10 | SR0114 | TENDITORE CATENA ASA80 |
| 11 | SR0147 | GUARNIZIONE |
| 12 | SR0140 | PIATTO DI CHIUSURA |
| 13 | B870017 | ROSETTA PER M10 UNI 6593 |
| 14 | B90011 | VITE M10x65 UNI 5737 |

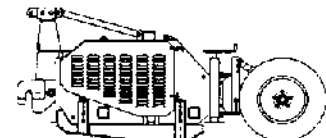

INNESTI PUNTA

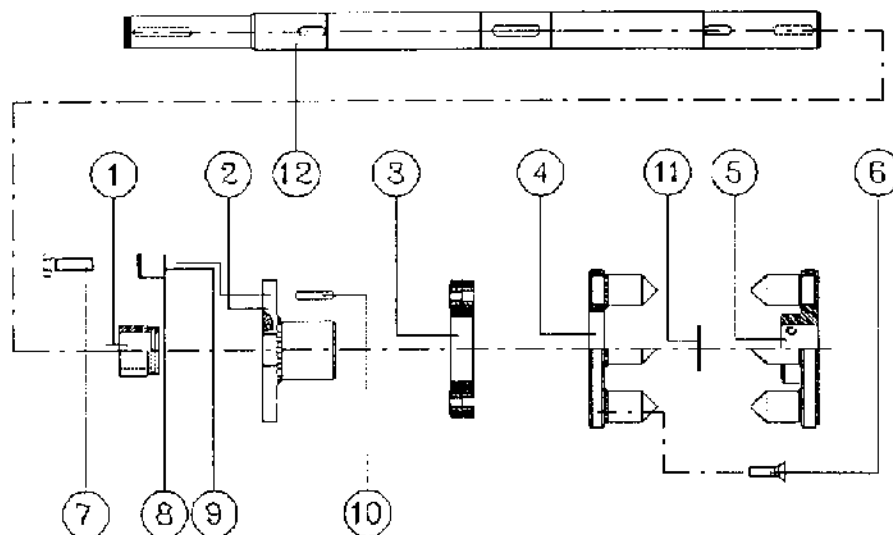

| POS. | CODICE | DESCRIZIONE |
|------|---------|--------------------------------|
| 1 | SR0119 | DISTANZIALE CON OR REG. 75-80 |
| 1 | SR0119 | DISTANZIALE CON OR REG. 70 |
| 2 | SR0620 | FLANGIA PORTA GOMMA REG. 75-80 |
| 2 | SR0730 | FLANGIA PORTA GOMMA REG. 70 |
| 3 | SR0568 | GIUNTO IN GOMMA |
| 4 | SR0639 | INNESTO DX REG. 75-80 |
| 4 | SR0740 | INNWSTO DX REG. 70 |
| 4 | SR0640 | INNESTO SX REG. 75-80 |
| 4 | SR0732 | INNESTO SX REG. 70 |
| 5 | SR0637 | INNESTO D=45 DX REG. 75-80 |
| 5 | SR0729 | INNESTO D=45 DX REG. 70 |
| 5 | SR0638 | INNESTO D=45 SX REG. 75-80 |
| 5 | SR0638 | INNESTO D=45 SX REG. 70 |
| 6 | B900007 | VITE M10x35 UNI 5933 |
| 6 | B890015 | VITE M10x30 UNI 5933 |
| 7 | B92012 | VITE M12x40 UNI 5739 |
| 7 | B92037 | VITE TSEI M10x25 UNI 5933 |
| 8 | B870017 | ROSETTA PER M10 UNI 6593 |
| 9 | B870033 | R.D.E. PER M10 UNI 8842 |
| 10 | B870024 | LINGUETTA 8x7x45 |
| 11 | B870238 | ANELLO ELAST. E35 UNI 7435-75 |
| 12 | SR0521 | ALBERO RIBALTABILE REG. 80 |
| 12 | SR0121 | ALBERO RIBALTABILE REG. 75 |
| 12 | SR0759 | ALBERO RIBALTABILE REG. 70 |

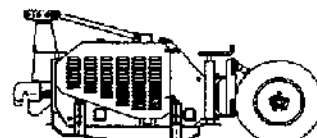
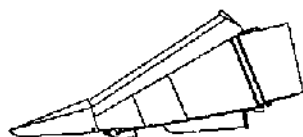

INNESTO TRINCIASTOCCHI

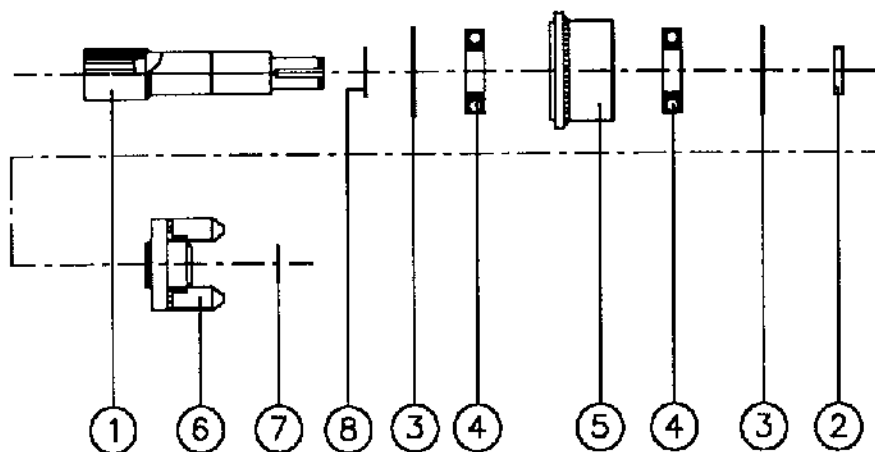

| POS. | CODICE | DESCRIZIONE |
|------|---------|-------------------------------------|
| 1 | SR0312 | ALBERO TRASMIS. TRINCIASTOCCHI |
| 2 | SR0325 | DISTANZIALE TRASMIS. TRINCIASTOCCHI |
| 3 | B870087 | ANELLO ELAST. J80 UNI 7437-75 |
| 4 | CU9207 | CUSCINETTO RADIALE 6208-Z |
| 5 | SR0327 | BUSSOLA CON FLANGIA |
| 6 | SR0323 | INNESTO SX TRINCIASTOCCHI |
| 6 | SR0321 | INNESTO DX TRINCIASTOCCHI |
| 7 | B870025 | ANELLO ELAST. E30 UNI 7435-75 |
| 8 | B870052 | ANELLO ELAST. UNI 7435-75 |

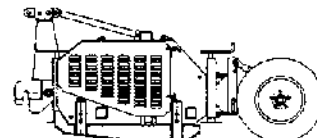

TRINCIASTOCCHI

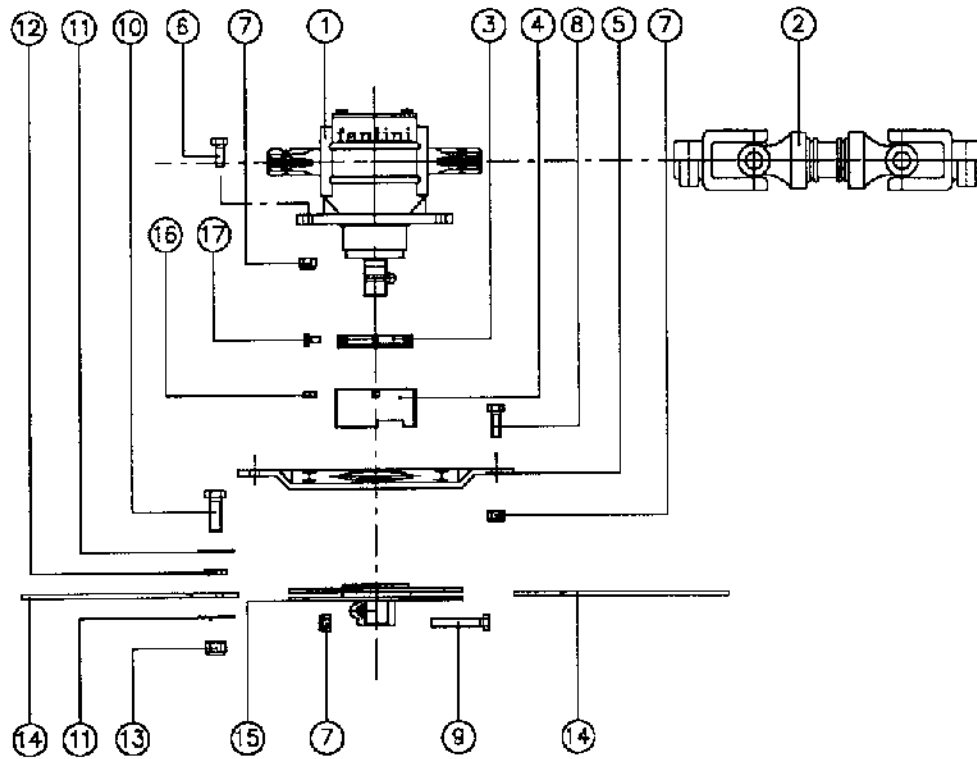

| POS. | CODICE | DESCRIZIONE |
|------|------------|--------------------------------|
| 1 | SP88100 | MOLTIPLICATORE |
| 2 | SP045871 | CARDANO PER REG. 75 |
| 2 | SP044871 | CARDANO PER REG. 80 |
| 3 | 91034 | RONDELLA DI SPESSORE PER TRIC. |
| 4 | 91020 | PROTEZIONE SCAT. TR. CON ROND. |
| 5 | SP882616 | PIASTRA FISSAGGIO |
| 6 | B870027 | VITE M12x30 UNI 7539 |
| 7 | B870028 | DADO M12 ALTO AUTOBLOCCANTE |
| 8 | B870041 | VITE M12x35 UNI 5739 |
| 9 | B90002 | VITE M12x70 UNI 5737 |
| 10 | B870101 | VITE M16x45 UNI 5739 |
| 11 | B91024 | GREMBIALINA 16x48x3 UNI 6593 |
| 12 | SP882603 | BOCCOLA PER TRINC. TEMPRATA |
| 13 | B870059 | DADO M16 ALTO AUTOBLOCCANTE |
| 14 | SP882602/A | COLTELLO L-260 |
| 14 | SP882602 | COLTELLO L-290 |
| 14 | SP882602/B | COLTELLO L-310 |
| 15 | SP882617 | SUPPORTO COLTELLI |
| 16 | B92097 | GRANO A COPPA M8x16 UNI 5929 |
| 17 | B870030 | VITE M8x16 UNI 5739 |

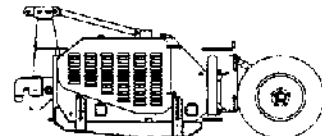
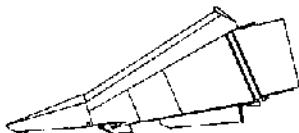

SCATOLA TRINCIASDOCCHI

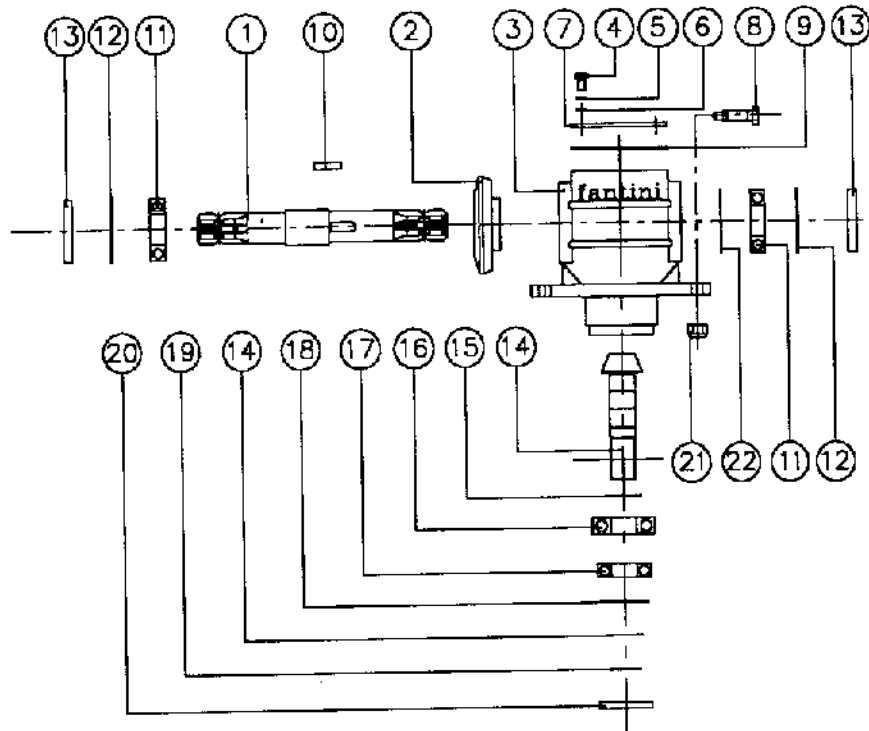

| POS. | CODICE | DESCRIZIONE |
|------|----------|-------------------------------|
| 1 | SP87110 | ALBERO SCATOLA TRINC. |
| 2 | SP87109 | CORONA Z28 M4 |
| 3 | SP87116 | SCATOLA TRINC. VUOTA |
| 4 | B900039 | VITE M8x14 UNI 5739 |
| 5 | B870037 | R.D.F. PER M6 UNI 8842 |
| 6 | B870036 | ROSETTA PER M6 UNI 6593 |
| 7 | SP87101 | COPERCHIO SCATOLA 120x5x120 |
| 8 | B870027 | VITE M12x30 UNI 5739 |
| 9 | SP87102 | GUARNIZIONE 120x3x120 |
| 10 | B870242 | LINGUETTA 10x8x30 RON. |
| 11 | CU870014 | CUSCINETTO 6207 |
| 12 | B870085 | ANELLO ELAST. 172 UNI 7437-75 |
| 13 | B870240 | ANELLO DI TENUTA 35x72x10 |
| 14 | SP87108 | PIGNONE Z10 M4 |
| 15 | B870077 | RONDELLA DI RASAM. 30x42x0.5 |
| 16 | CU870001 | CUSCINETTO 6306 |
| 17 | CU870002 | CUSCINETTO 6206-2RS |
| 18 | B870243 | ANELLO NYLOS 6206 AV |
| 19 | B870025 | ANELLO ELAST. F30 UNI 7435-75 |
| 20 | B870021 | ANELLO DI TENUTA 30x62x7 |
| 21 | B870028 | DADO M12 ALTO AUTOBLOCCANTE |
| 22 | B91023 | RONDELLA DI RASAM. 60.3x71.7 |

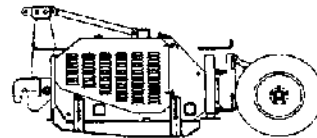
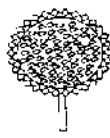

PUNTA

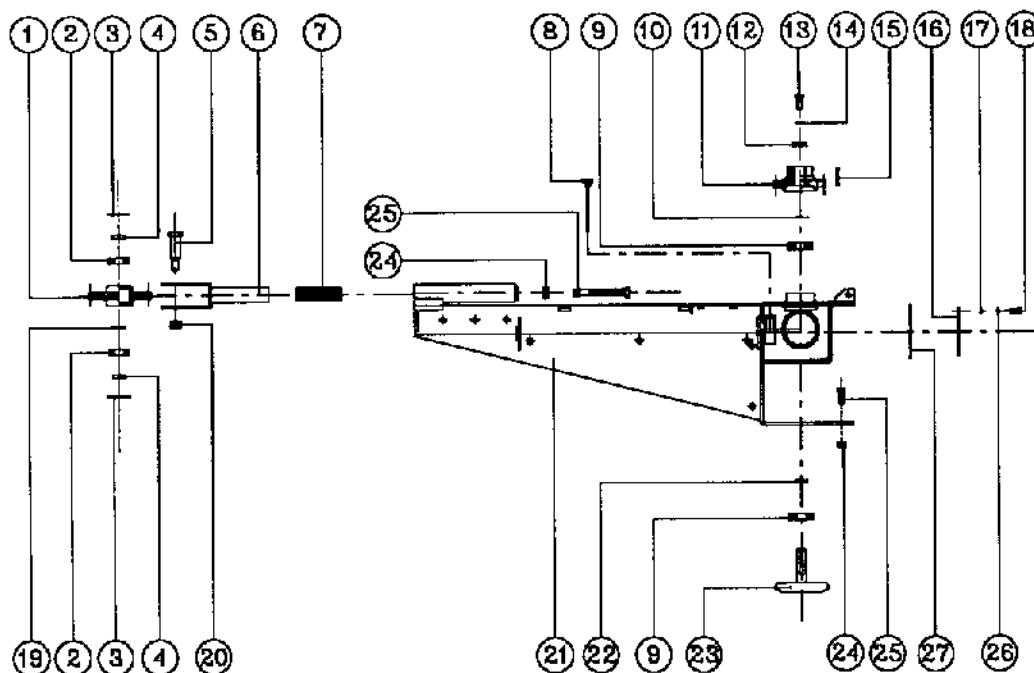

| POS. | CODICE | DESCRIZIONE |
|------|----------|--------------------------------|
| 1 | SP882908 | PIGNONE GHISA Z11 PASSO 41.4 |
| 2 | CU870010 | CUSCINETTO 6205 2RS |
| 3 | B870065 | ANELLO ELAST. I52 UNI 7427-75 |
| 4 | GS871312 | DISTANZIALE 32x3 7mm |
| 5 | GS871310 | PERNO ESAGONALE E30 |
| 6 | GS871333 | FORCELLA TENDICATENA |
| 7 | GS871334 | MOLLA PER FORCELLA TENDICATENA |
| 8 | P910002 | TAPPO DI LIVELLO DA 3/8 |
| 9 | CU870004 | CUSCINETTO 6305 2RS |
| 10 | B870061 | RONDELLA DI RASAM. 25x42x0.5 |
| 11 | SP882802 | PIGNONE Z9 PASSO 41.4 |
| 12 | SP871005 | RONDELLA 36x13x8 |
| 13 | B870027 | VITE M12x30 UNI 5739 |
| 14 | B870033 | R.D.E. PER M10 UNI 8842 |
| 15 | B870024 | LINGUETTA 8x7x45 |
| 16 | SP871015 | COPERCHIO SCATOLA SP |
| 17 | B870031 | ROSETTA PER M8 UNI 6592 |
| 18 | B870048 | VITE M8x20 UNI 5739 |
| 19 | GS871313 | DISTANZIALE 32x3 L=6mm |
| 20 | B870059 | DADO M16 ALTO AUTOBLOCCANTE |

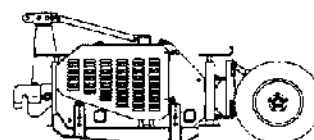
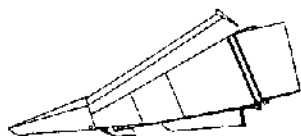

PUNTA

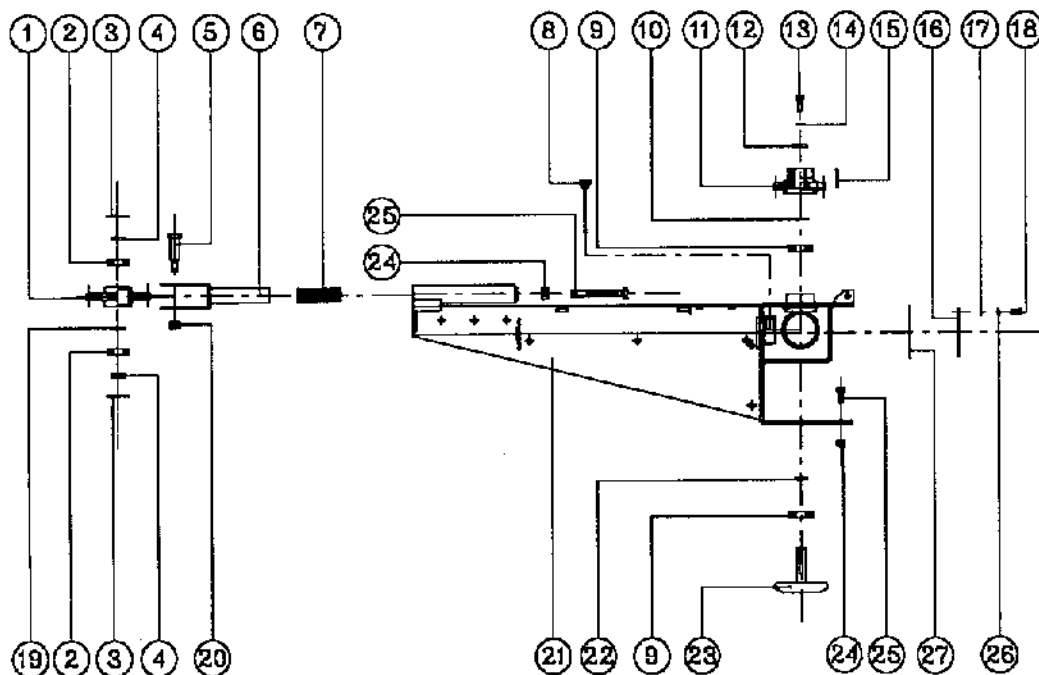

| POS. | CODICE | DESCRIZIONE |
|------|------------|-----------------------------|
| 21 | SP882900/A | TELAIO PUNTA CENTRALE |
| 21 | SR0594 | TELAIO PUNTA PH RINF. LAT. |
| 22 | SP871008 | SPESSORE |
| 23 | SP882809 | CORONA CON GAMBO Z27 M5 |
| 24 | B870028 | DADO M12 ALTO AUTOBLOCCANTE |
| 25 | B870027 | VITE M12x30 UNI 5739 |
| 26 | B870032 | R.D.E. PER M8 UNI 8842 |
| 27 | SP871016 | GUARNIZIONE GOMMA 120x3-290 |

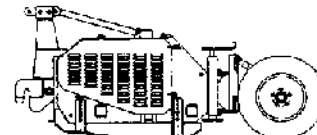
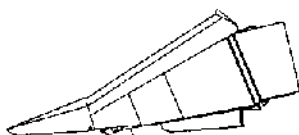

PUNTA

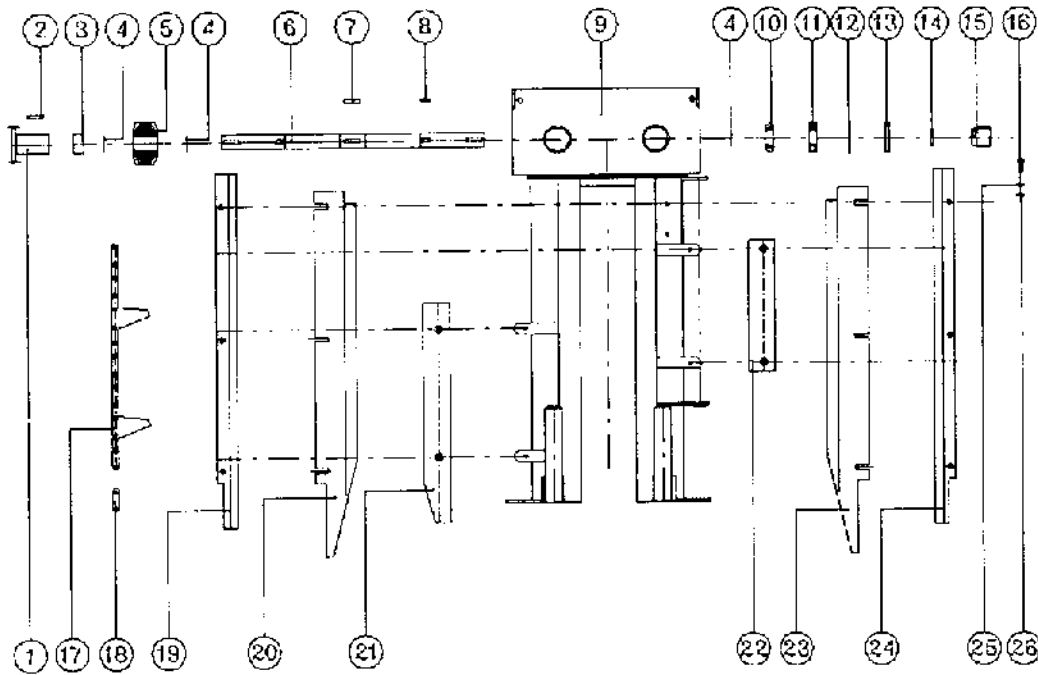

| POS. | CODICE | DESCRIZIONE |
|------|-------------|--------------------------------------|
| 1 | GS88425/70 | GIUNTO PER R 70 GS. CATENE |
| 1 | GS88425/75 | GIUNTO PER R 75 GS. CATENE |
| 1 | GS88425/80 | GIUNTO PER R 80 GS. CATENE |
| 2 | B870024 | LINGUETTA 8x7x45 |
| 3 | SP882803/70 | TUBO 48.3x8 LG=19 DIST.REG.70 |
| 3 | SP882803/75 | TUBO 48.3x8 LG=45 DIST.REG.75 |
| 3 | SP882803/80 | TUBO 48.3x8 LG=71 DIST.REG.80 |
| 4 | B870238 | ANELLO ELAST. E35 UNI 7435-75 |
| 5 | SP882811 | CORONA DOPPIA 7,22 M5 |
| 6 | SR0118 | ALBERO SCATOLA GRUPPO LATERALE FISSA |
| 6 | SP882810/L | ALBERO SCATOLA GRUPPO CENTRALE |
| 7 | B870104 | LINGUETTA 10x8x45 |
| 8 | B870098 | LINGUETTA 8x7x25 |
| 9 | SP882900/A | TELAIO PUNTA |
| 10 | SP882805 | INGRANAGGIO Z15 M5 |
| 11 | CU870006 | CUSCINETTO 6307 |
| 12 | B870087 | ANELLO ELAST. I80 UNI 7437-75 |
| 13 | P870003 | ANELLO DI TENUTA 45x80x10 |
| 14 | P870001 | O.R. 4137 |
| 15 | GS88422 | DISTANZIALE CON O.R. L=27mm |
| 16 | B870012 | VITE M10x25 UNI 5739 |
| 17 | C880001 | CATENA DI RACCOLTA CA550 61P |
| 18 | C890016 | MAGLIA GIUNZIONE CA550 |

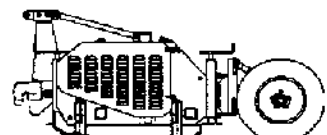
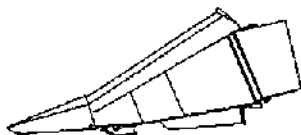

PUNTA

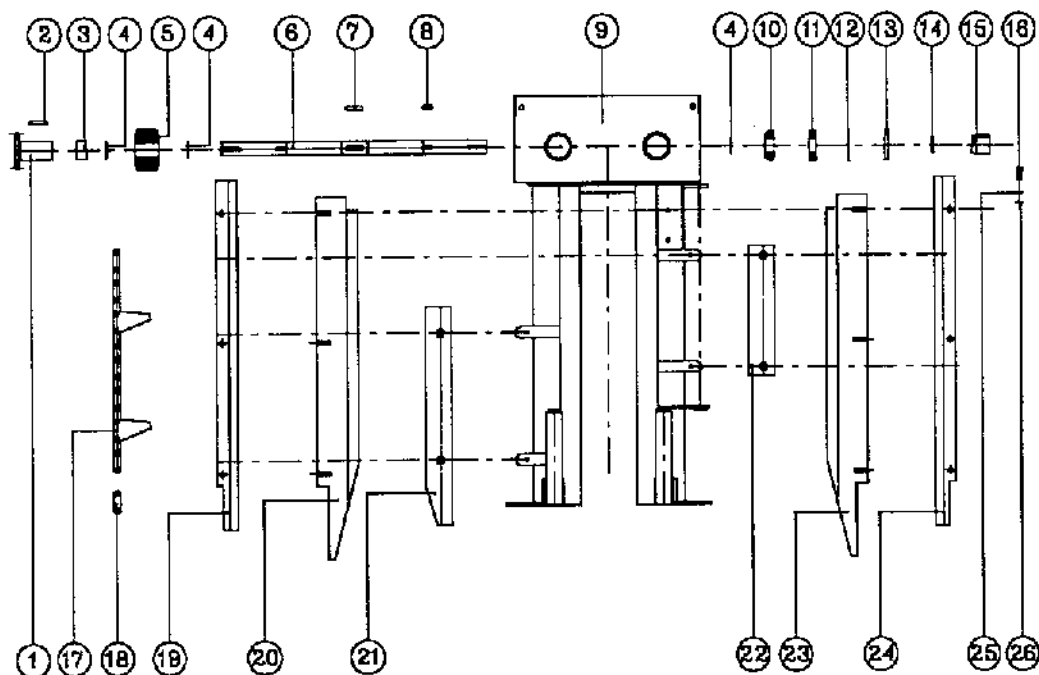

| POS. | CODICE | DESCRIZIONE |
|------|------------|-----------------------------|
| 19 | SP88910/D | GUIDA CAT. DI RACCOLTA DX |
| 20 | SP882907/B | LAMA STR. PAN. PIEG. DX |
| 20 | SP88912/D | LAMA STR. PAN. DX |
| 21 | SP882905/S | ASSICELLA DX |
| 22 | SP891201/A | ASSICELLA SX 70x15x350 L.E. |
| 22 | SP882905/S | ASSICELLA SX |
| 23 | SP882907/A | LAMA STR. PAN. PIEG. SX |
| 23 | SP88912/S | LAMA STR. PAN. SX |
| 24 | SP88910/S | GUIDA CATENA SX |
| 25 | B870033 | R.D.E. PER M10 UNI 8842 |
| 26 | B870017 | ROSETTA PER M10 UNI 6593 |

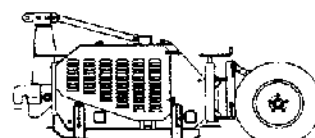

RULLO MUNGITORE

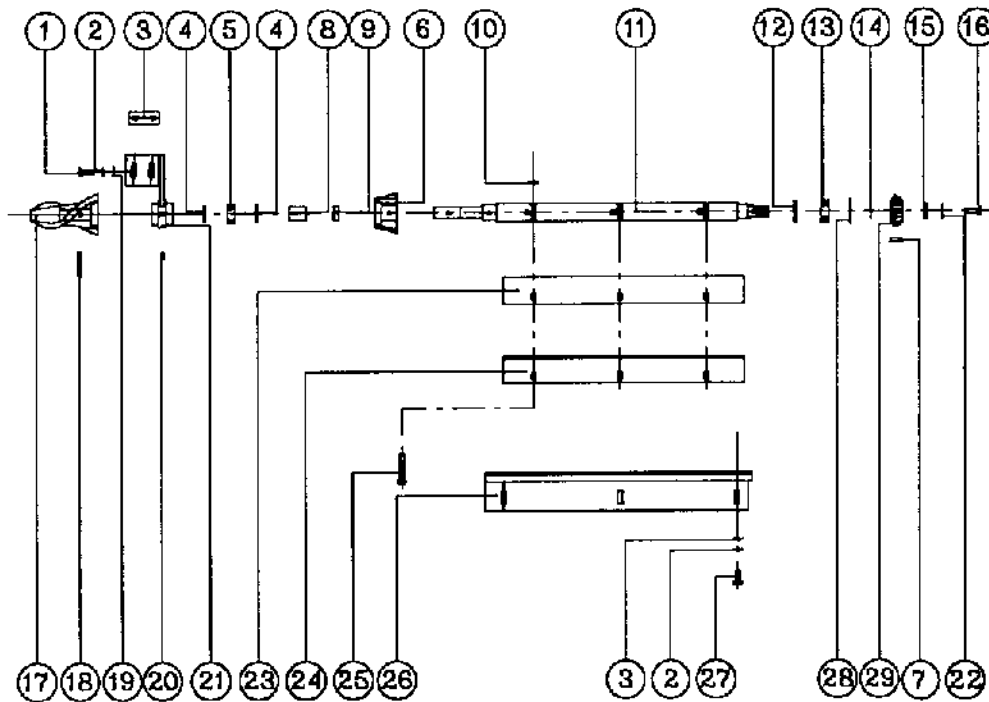

| POS. | CODICE | DESCRIZIONE |
|------|-----------|-------------------------------|
| 1 | B870067 | VITE M10x30 UNI 5739 |
| 2 | B870033 | R.D.E. PER M10 UNI 8842 |
| 3 | SP88608 | PIATTO SUPPORTO RULLI 30x4x70 |
| 4 | P870004 | ANELLO DI TENUTA 30x37x4 DM |
| 5 | CU870007 | CUSCINETTO A RULLINI DHK 3038 |
| 6 | SP88609/D | PRIMARIO DESTRO IN GHISA |
| 6 | SP88609/S | PRIMARIO SINISTRO IN GHISA |
| 7 | B870002 | LINGUETTA 8x7x30 UNI 6604-69A |
| 8 | CU870009 | BOCCOLA LR 25x30x38.5 |
| 9 | CU870008 | BOCCOLA LR 25x30x12.5 |
| 10 | B870013 | DADO M10 h=8 FLANG. TEMPRATO |
| 11 | SP88601 | ALBERO QUADRO 40x40x722 |
| 12 | B870064 | ANELLO DI TENUTA 32x45x7 DPSM |
| 13 | CU870005 | CUSCINETTO 2205-2RS |
| 14 | SP871019 | DISTANZIALE 32x3 L=5 |
| 15 | SP871021 | RONDELLA 33x10.5x6 |
| 16 | B870067 | VITE M10x30 UNI 5739 |
| 17 | SP88610/D | PUNTA IN GHISA DESTRA |
| 17 | SP88610/S | PUNTA IN GHISA SINISTRA |
| 18 | B870093 | SPINA ELAST. 8x55 UNI 6875-71 |
| 19 | B870017 | ROSETTA PER M10 UNI 6593 |
| 20 | B870092 | INGRASSATORE 1/8 GAS DIRITTO |

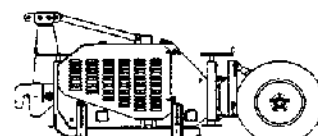
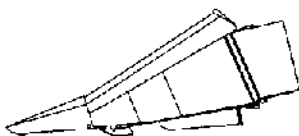

RULLO MUNGITORE

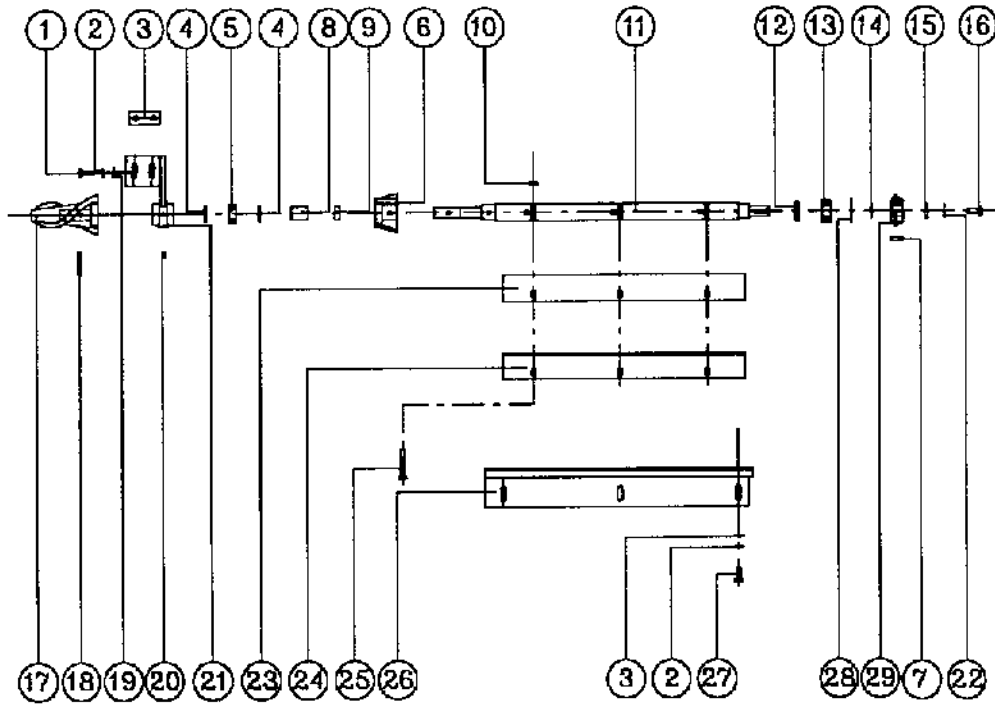

| POS. | CODICE | DESCRIZIONE |
|------|-----------|-------------------------------|
| 21 | SP88612/D | SUPPORTO ANTERIORE RULLO DX |
| 21 | SP88612/S | SUPPORTO ANTERIORE RULLO SX |
| 22 | B870066 | GREMBIALINA 10x30x1 UNI 6593 |
| 23 | FA70025 | COLTELLO NORMALE |
| 24 | SP88602/R | COLTELLO CR DESTRO |
| 24 | SP88602/L | COLTELLO CR SINISTRO |
| 25 | 890001 | VITE M10x60 UNI 5739 |
| 26 | SP88913/D | CONTRO COLTELLO DESTRO |
| 26 | SP88913/S | CONTRO COLTELLO SINISTRO |
| 27 | B870012 | VITE M10x25 UNI 5739 |
| 28 | B870065 | ANELLO ELAST. I52 UNI 7437-35 |
| 29 | SP871020 | PIGNONE Z13 M5 |

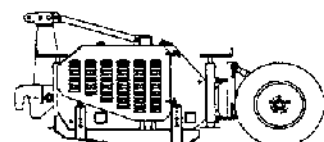
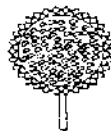
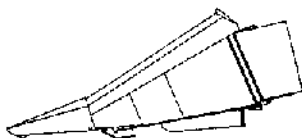

COFANTURA

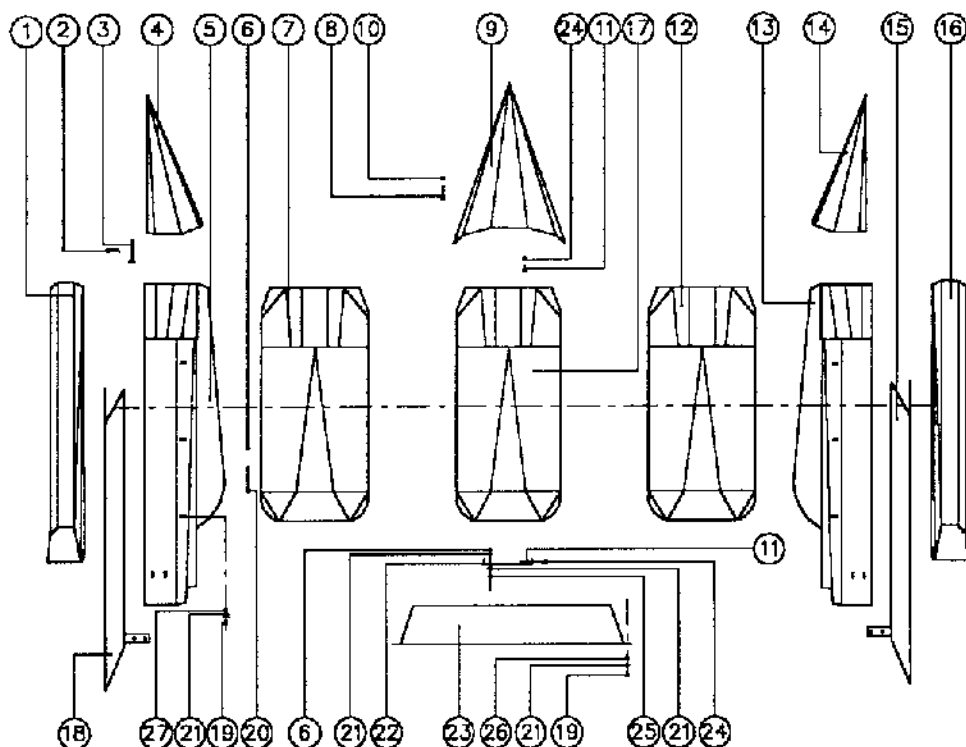

| POS. | CODICE | DESCRIZIONE |
|------|----------|--------------------------------|
| 1 | SR0439 | SOVRASPONDA BASSA SX |
| 1 | SR0487 | SOVRASPONDA ALTA SX |
| 2 | BZ870029 | COPIGLIA FI. mm3.5 UNI 8833 Z. |
| 3 | SR0671 | SPINA PER PUNTA SPARTIFILE RIB |
| 4 | SR0214 | PUNTA LATERALE SX |
| 5 | SR0438 | COFANO LAT. SX BASSO SP. PH. |
| 6 | B870019 | DADO M8 ALTO AUTOBLOCCANTE |
| 7 | SR0591 | COFANO LAT. PUNTA RIB. SX R70 |
| 7 | SR0209 | COFANO LAT. PUNTA RIB. SX R75 |
| 7 | SR0542 | COFANO LAT. PUNTA RIB. SX R80 |
| 8 | HZ92120 | VITE M10x70 UNI 5739 ZINCATA |
| 9 | SR0781 | PUNTA CENTRALE R70 RIBALTAB. |
| 9 | SR0212 | PUNTA CENTRALE R75 RIBALTAB. |
| 9 | SR0540 | PUNTA CENTRALE R80 RIBALTAB. |
| 10 | BZ92116 | DADO M10 MEDIO ZINC. UNI 5588 |
| 11 | BZ870010 | VITE M10x25 ZINC. UNI 5739 |
| 12 | SR0592 | COFANO LAT. PUNTA RIB. DX R70 |
| 12 | SR0208 | COFANO LAT. PUNTA RIB. DX R75 |
| 12 | SR0541 | COFANO LAT. PUNTA RIB. DX R80 |
| 13 | SR0210 | COFANO LAT. DX BASSO SP. PH. |
| 14 | SR0213 | PUNTA LATERALE DX |
| 15 | SR0488 | SPONDA DX COCLEA |
| 16 | SR0440 | SOVRASPONDA BASSA DX |
| 16 | SR0486 | SOVRASPONDA ALTA DX |
| 17 | SR0593 | COFANO CENTRALE R70 SP. PH. |

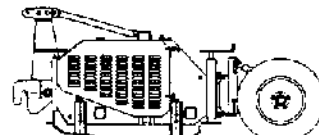
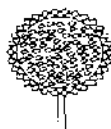

COFANATURA

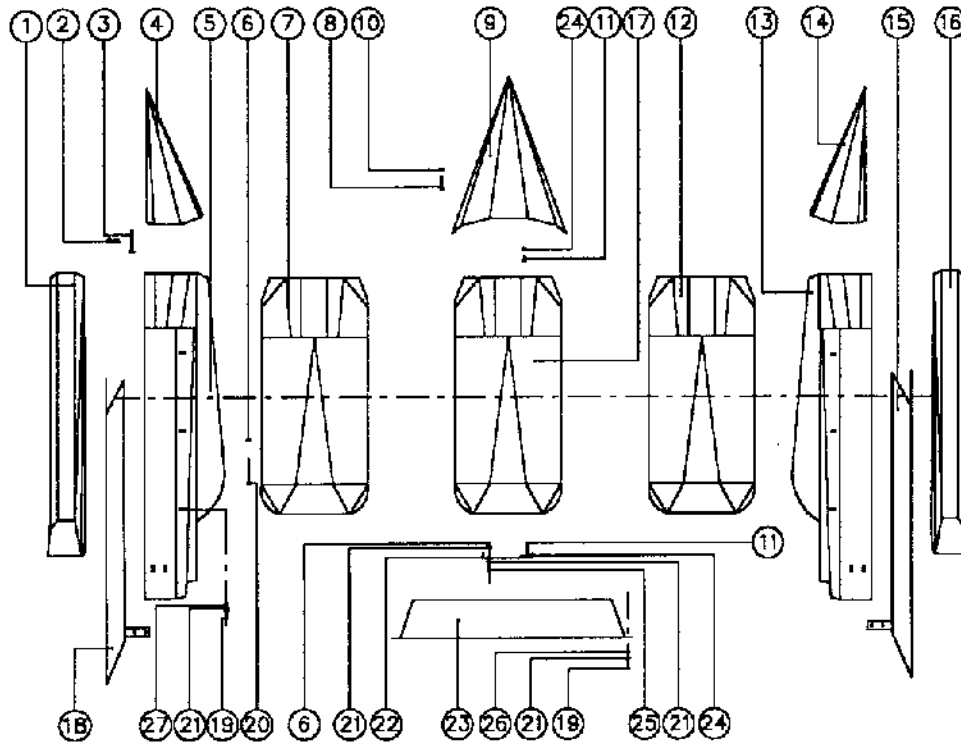

| POS. | CODICE | DESCRIZIONE |
|------|----------|--------------------------------|
| 17 | SR0207 | COFANO CENTRALE R75 SP. PH. |
| 17 | SR0543 | COFANO CENTRALE R80 SP. PH. |
| 18 | SR0489 | SPONDA SX COCLEA |
| 19 | BZ870030 | VITE M8x20 ZINC. UNI 5739 |
| 20 | SR0673 | VITE PER COFANO LAT. RIB. |
| 21 | BZ870022 | GREMBIALINA 8x24 UNI 6593 ZINC |
| 22 | SP882725 | PIATTO FISSAGGIO COFANO R70 |
| 22 | SP882726 | PIATTO FISSAGGIO COFANO R75 |
| 22 | SP882727 | PIATTO FISSAGGIO COFANO R80 |
| 23 | SR0341 | PROTEZIONE COCLEA ZINCATA |
| 24 | B870006 | DADO M10 ALTO AUTOBLOCCANTE |
| 25 | BZ870016 | VITE M8x25 UNI 5739 ZINCATA |
| 26 | BZ870014 | R.D.E. PER M8 UNI 8842 ZINCATA |
| 27 | B92031 | DADO FLANGIATO M8 |

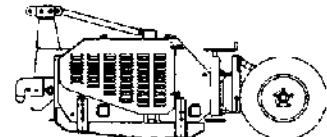

CARTER INTERFILA - ASTE LAME ELETTRICHE

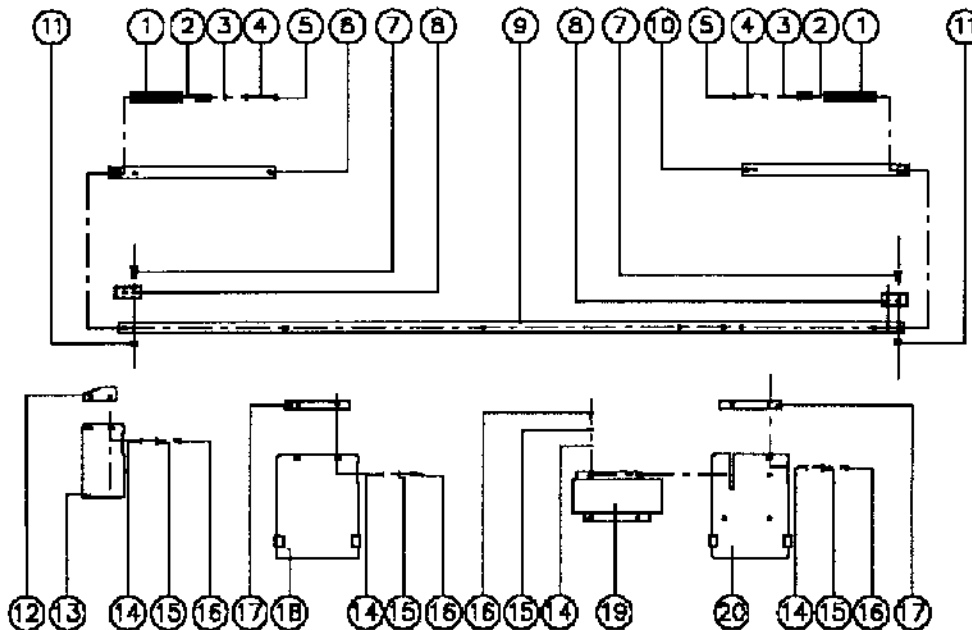

| POS. | CODICE | DESCRIZIONE |
|------|----------|-------------------------------|
| 1 | SR0301 | MOLLA DI RITORNO |
| 2 | SR0892 | PERNO PER MOLLA DI RITORNO |
| 3 | BZ870034 | R.D.E. PER M10 UNI 8842 |
| 4 | BZ870011 | ROSETTA PER M10 ZINCATA |
| 5 | B870067 | VITE M10x30 UNI 5739 |
| 6 | SR0309 | ASTA COMANDO DX R.75 |
| 7 | B91001 | VITE TSEI M12x35 UNI 5933 |
| 8 | SR0306 | PIATTO APOGGIO ASTA L.E. |
| 9 | SR0789 | ASTA CENTR. COMANDO I.F. R.70 |
| 9 | SR0308 | ASTA CENTR. COMANDO L.E. R.75 |
| 9 | SR0790 | ASTA CENTR. COMANDO L.E. R.80 |
| 10 | SR0893 | ASTA COMANDO SX R.70 |
| 10 | SR0302 | ASTA COMANDO SX R.75 |
| 10 | SR0894 | ASTA COMANDO SX R.80 |
| 11 | B870028 | DADO M12 ALTO AUTOBLOCCANTE |
| 12 | SR0795 | CARTER SUPERIORE DX R.70 |
| 12 | SR0796 | CARTER SUPERIORE SX R.70 |
| 12 | SR0703 | CARTER SUPERIORE DX R.75 |
| 12 | SR0705 | CARTER SUPERIORE SX R.75 |
| 12 | SR0709 | CARTER SUPERIORE DX R.80 |
| 12 | SR0710 | CARTER SUPERIORE SX R.80 |
| 13 | SR0792 | LAMIERA CARTER DX R.70 |
| 13 | SR0793 | LAMIERA CARTER SX R.70 |
| 13 | SR0432 | LAMIERA CARTER DX R.75 |
| 13 | SR0436 | LAMIERA CARTER SX R.75 |

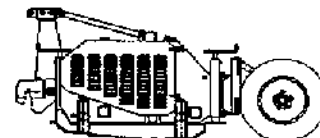
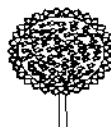
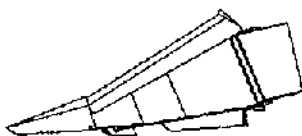

CARTER INTERFILA - ASTE LAME ELETTRICHE

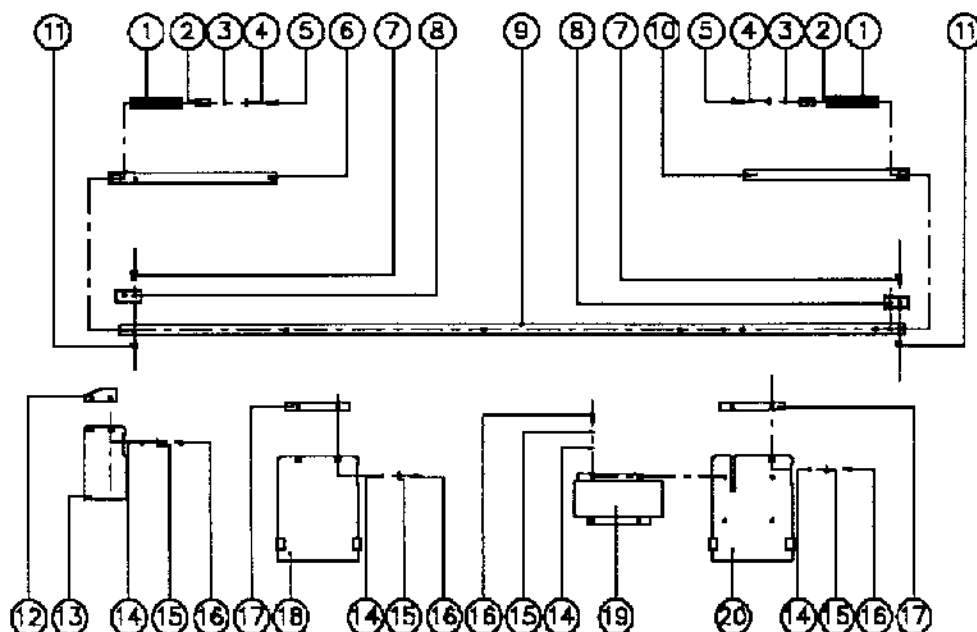

| POS. | CODICE | DESCRIZIONE |
|------|--------------|--------------------------------|
| 13 | SR0442 | LAMIERA CARTER DX R.80 |
| 13 | SR0444 | LAMIERA CARTER SX R.80 |
| 14 | BZ870022 | GREMBIALINA 8x24 UNI 6593 ZINC |
| 15 | BZ870014 | R.D.E. PER M8 UNI 8842 ZINC. |
| 16 | BZ870030 | VITE M8x20 UNI 5739 ZINCATA |
| 17 | SP891213A/70 | CARTER SUPERIORE INTERFILA |
| 17 | SP891213A/75 | CARTER SUPERIORE INTERFILA |
| 17 | SP891213A/80 | CARTER SUPERIORE INTERFILA |
| 18 | SP891211A/70 | CARTER INTERFILA ANTERIORE |
| 18 | SP891211A/75 | CARTER INTERFILA ANTERIORE |
| 18 | SP891211A/80 | CARTER INTERFILA ANTERIORE |
| 19 | SP891212A/70 | PROTEZIONE ATTUATORE |
| 19 | SP891212A/75 | PROTEZIONE ATTUATORE |
| 19 | SP891212A/80 | PROTEZIONE ATTUATORE |
| 20 | SP891211B/70 | CARTER ANTERIORE I.E. |
| 20 | SP891211B/75 | CARTER ANTERIORE I.E. |
| 20 | SP891211B/80 | CARTER ANTERIORE I.E. |

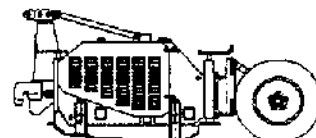
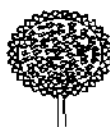
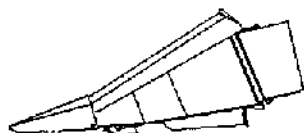

IMPIANTO LAME ELETTRICHE

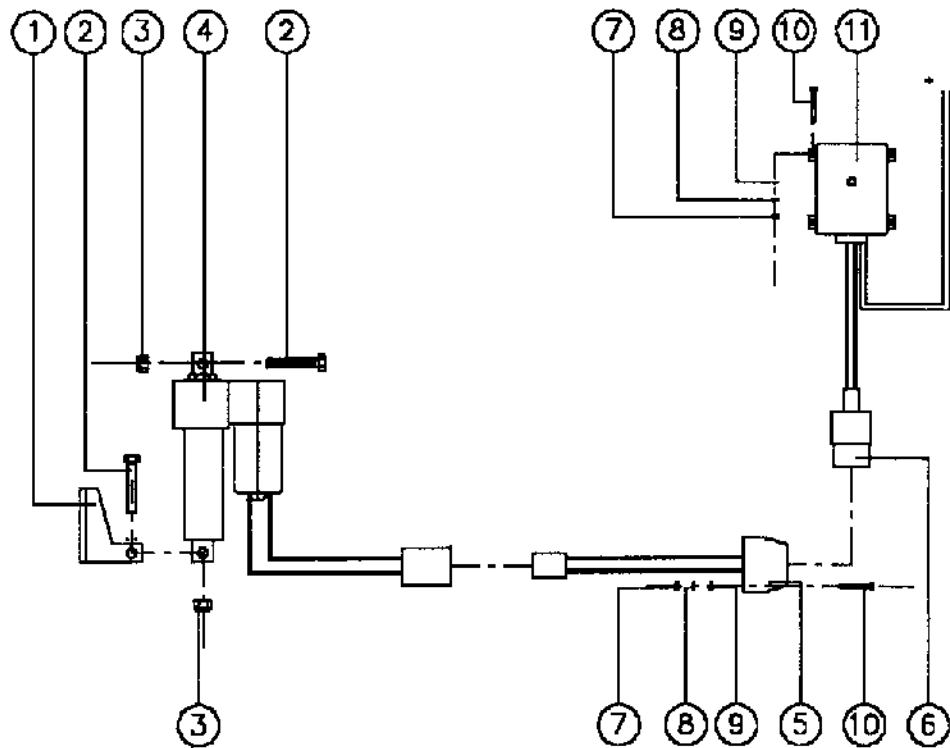

| POS. | CODICE | DESCRIZIONE |
|------|-----------|--------------------------------|
| 1 | SP891203A | ASTA AGGANCIO |
| 2 | B90002 | VITE M12x70 UNI 5737 |
| 3 | B870028 | DADO M12 ALTO AUTOBLOCCANTE |
| 4 | SP891216 | ATTUATORE LINEARE 2200 N |
| 5 | SP891220 | SPINA FEMMINA |
| 6 | SP891219 | SPINA MASCHIO |
| 7 | BZ890006 | DADO M5 ALTO UNI 5587 ZINC. |
| 8 | BZ890007 | R.D.E. PER M5 UNI 8842 ZINC. |
| 9 | BZ890008 | ROSETTA PER M5 ZINCATA |
| 10 | BZ890005 | VITE TC M5x40 UNI 6107 ZINC. |
| 11 | SP891218 | CENTRALINA COMANDO ATTU.MCS302 |

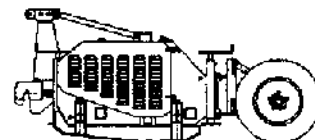
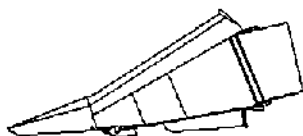

LAMELETTRICHE

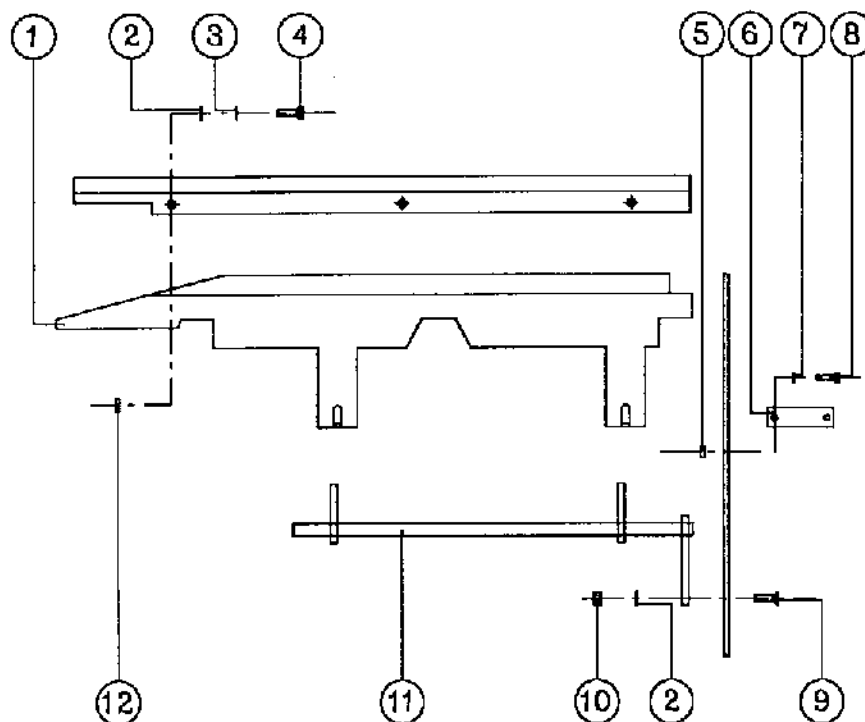

| POS. | CODICE | DESCRIZIONE |
|------|------------|-----------------------------|
| 1 | SP891206/A | LAMA STRAPPAPANOCCHIA SX |
| 2 | B870017 | ROSETTA PER M10 UNI 6593 |
| 3 | B870033 | R.D.E. PER M10 UNI 8842 |
| 4 | B870067 | VITE M10x30 UNI 5739 |
| 5 | SP891208/A | SPESORE 18x6.5 |
| 6 | SP891215/A | PIASTRINA DI FISSAGGIO LAMA |
| 7 | B870031 | ROSETTA PER M8 UNI 6592 |
| 8 | B900008 | VITE M8x30 UNI 5739 |
| 9 | B900007 | VITE TSEI M10x35 UNI 5933 |
| 10 | B870006 | DADO M12 ALTO AUTOBLOCCANTE |
| 11 | SP891210 | BILANCERE |
| 11 | SP891210/L | BILANCERE LATERALE |
| 12 | SP891207/A | DISTANZIALE 20x5 L=6.5 |

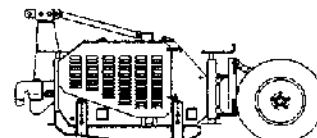
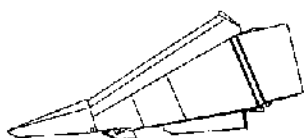

LAME ELETTRICHEà

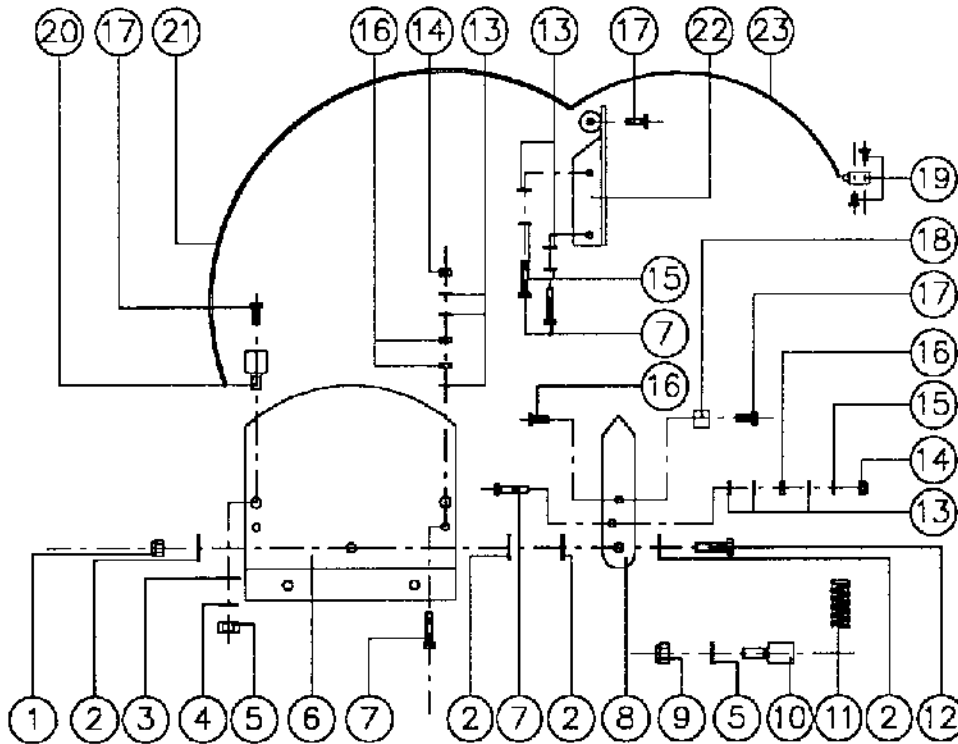

| POS. | CODICE | DESCRIZIONE |
|------|------------|--------------------------------|
| 1 | B870019 | DADO M8 ALTO AUTOBLOCCANTE |
| 2 | BZ870022 | GRIMBIALINA 8x24 UNI 6593 ZINC |
| 3 | B870017 | ROSETTA PER M10 UNI 6593 |
| 4 | B870033 | R.D.E. PER M10 UNI 8842 |
| 5 | B870034 | DADO M10 ALTO UNI 5587 |
| 6 | SP0095 | SEGNA CORSA MOD. 1993 |
| 7 | BZ91028 | VITE M6x30 UNI 5739 ZINC. |
| 8 | SP0096 | INDICATORE PER L.E. MOD. 1993 |
| 9 | B870006 | DADO M10 ALTO AUTOBLOCCANTE |
| 10 | SP891218/A | FERMA FILO PER ASTA |
| 11 | SP891607 | MOLLA PER INDICATORE L.E. |
| 12 | BZ870018 | VITE M8x30 UNI 5739 ZINC. |
| 13 | BZ91029 | ROSETTA PER M6 UNI 6592 ZINC. |
| 14 | B870040 | DADO M6 AUTOBLOCCANTE BASSO |
| 15 | BZ91030 | R.D.E. PER M6 UNI 8842 ZINC. |
| 16 | BZ91032 | DADO M6 UNI 5588 ZINC. |
| 17 | BZ91027 | VITE M6x16 UNI 5739 ZINC. |
| 18 | SP891218/B | FERMA FILO PER INDICATORE |
| 19 | SP891608 | MORSETTO |
| 20 | SP891219/A | FERMO GUAINA PICCOLO |
| 21 | SP891606 | GUAINA FLESSIBILE |
| 22 | SP891220/A | FERMO GUAINA |
| 23 | SP891605 | FILO PER GUAINA |

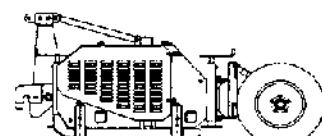
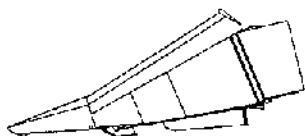

COFANATURA LATERALE

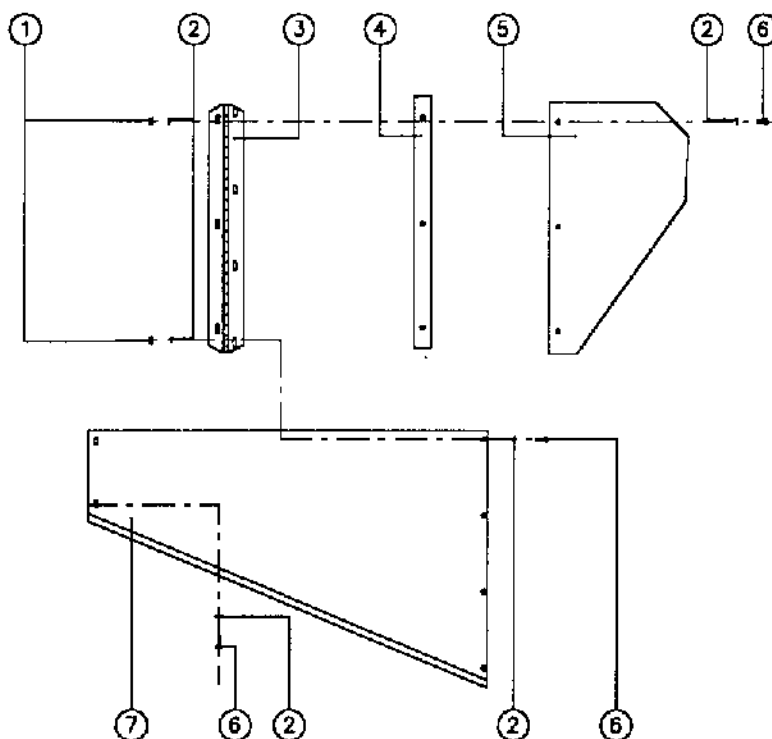

| POS. | CODICE | DESCRIZIONE |
|------|----------|-------------------------------|
| 1 | B92031 | DADO M8 FLANGIATO |
| 2 | BZ870013 | ROSETTA PER M8 ZINCATA |
| 3 | 90109 | CERNIERA PER CARTER LATERALI |
| 4 | SR0520 | SUPPORTO CERNIERE CARTER LAT. |
| 5 | SR0461 | CARTER POSTERIORE DX |
| 5 | SR0462 | CARTER POSTERIORE SX |
| 6 | BZ870016 | VITE M8x25 UNI 5739 ZINCATA |
| 7 | SR0459 | ALETTA DX |
| 7 | SR0460 | ALETTA SX |

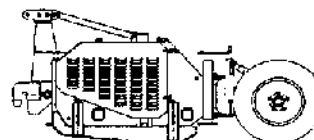
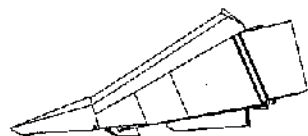

PROTEZIONE TRINCIAS TOCCHIò

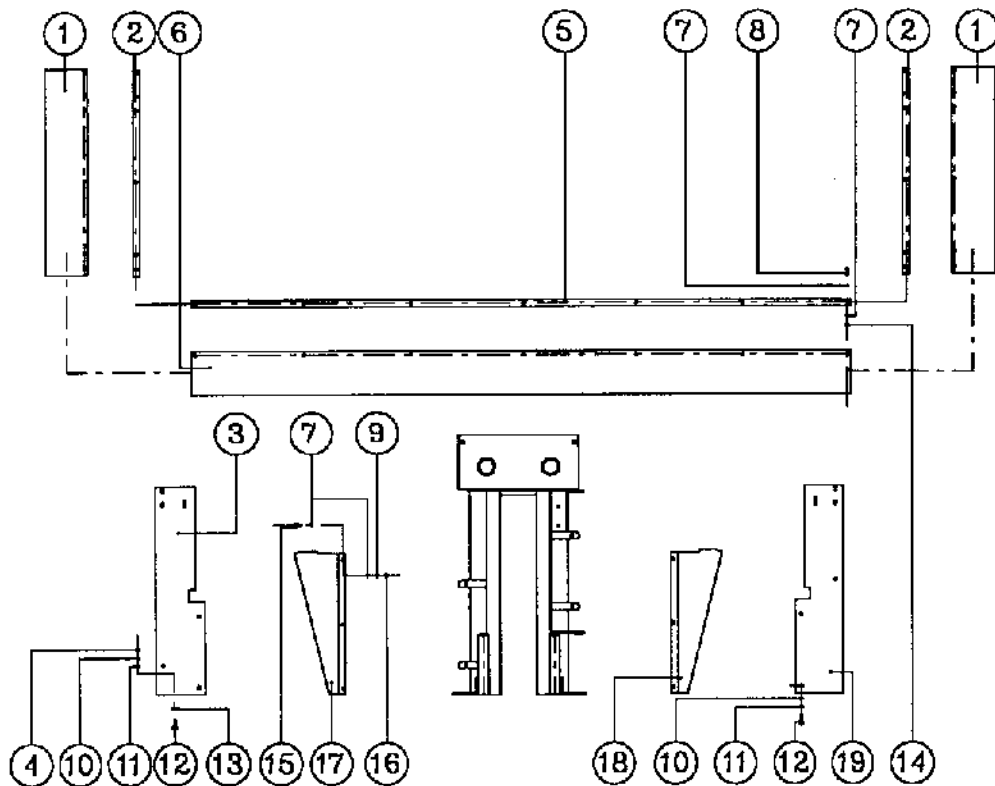

POS. CODICE DESCRIZIONE

| | | |
|----|------------|--------------------------------|
| 1 | SR0694 | GOMMA PROT. TRINC. LAT. R.70 |
| 1 | SR0661 | GOMMA PROT. TRINC. LAT. R.75 |
| 1 | SR0662 | GOMMA PROT. TRINC. LAT. R.80 |
| 2 | SR0693 | FISSAG. GOMMA TR. TEL.RIB.R.70 |
| 2 | SR0654 | FISSAG. GOMMA TR. TEL.RIB.R.75 |
| 2 | SR0693 | FISSAG. GOMMA TR. TEL.RIB.R.80 |
| 3 | SP882607/D | PROTEZIONE LAT. TRINC. DX |
| 4 | B870034 | DADO M10 ALTO UNI 5587 |
| 5 | SR0696 | FISSAGGIO GOMMA TEL. FIS. R.70 |
| 5 | SR0655 | FISSAGGIO GOMMA TEL. FIS. R.75 |
| 5 | SR0656 | FISSAGGIO GOMMA TEL. FIS. R.80 |
| 6 | SR0695 | GOMMA PROT. TELAIO FISSO R.70 |
| 6 | SR0659 | GOMMA PROT. TELAIO FISSO R.75 |
| 6 | SR0660 | GOMMA PROT. TELAIO FISSO R.80 |
| 7 | BZ870013 | ROSETTA PER M8 UNI 6592 ZINC. |
| 8 | BZ870018 | VITE M8x30 UNI 5739 ZINCATA |
| 9 | B870032 | R.D.E. PER M8 UNI 8842 |
| 10 | BZ870033 | R.D.E. PER M10 UNI 8842 |
| 11 | B870017 | ROSETTA PER M10 UNI 6593 |
| 12 | B870012 | VITE M10x25 UNI 5739 |
| 13 | B870005 | GREMBIALINA 10x30x3 UNI 6593 |
| 14 | BZ900006 | DADO FLANGIATO ZINCATO |

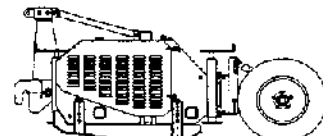
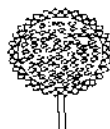

PROTEZIONE TRINCIASTOCCHI

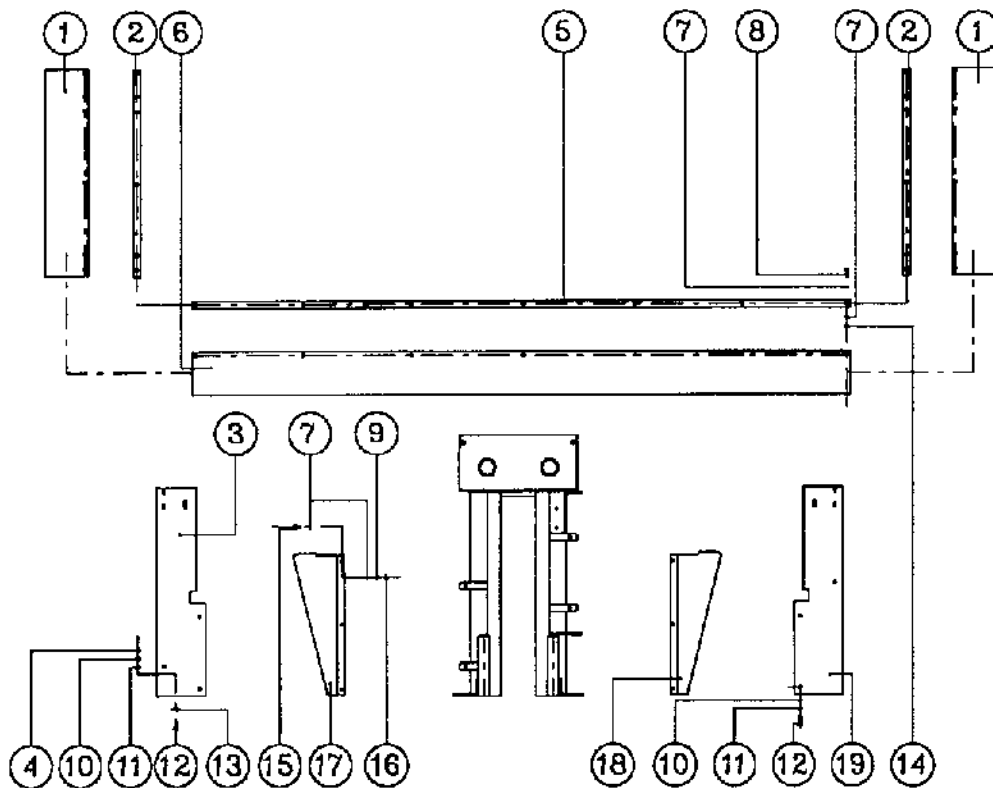

| POS. | CODICE | DESCRIZIONE |
|------|------------|---------------------------|
| 15 | B870048 | VITE M8x20 UNI 5739 |
| 16 | B870050 | DADO M8 ALTO UNI 5587 |
| 17 | SP882601/S | CARTER SINISTRO |
| 18 | SP882601/D | CARTER DESTRO |
| 19 | SP882607/S | PROTEZIONE LAT. TRINC. SX |

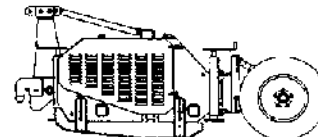
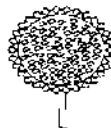
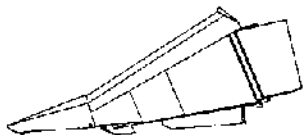

IMPIANTO IDRAULICO DI SOLLEVAMENTO SUPERIORE

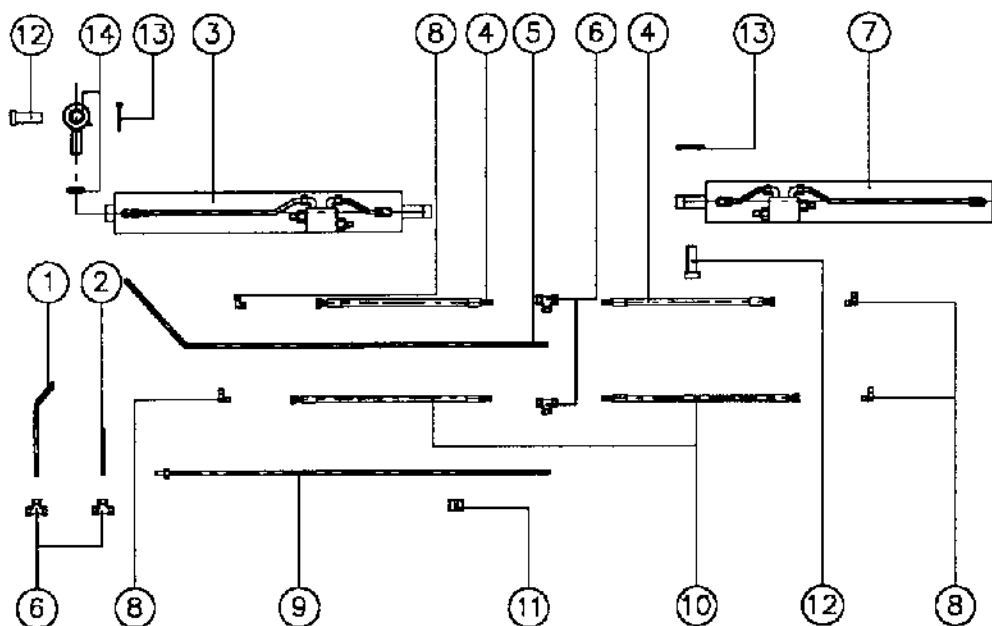

| POS. | CODICE | DESCRIZIONE |
|------|---------|---------------------------------|
| 1 | SR0806 | TUBO ZINCATO D10 SUPERIORE |
| 2 | SR0805 | TUBO ZINCATO D10 SUPERIORE |
| 3 | SR0112S | CILINDRO DI SOLLEVAMENTO SX |
| 4 | SR0274 | TUBO R2 1/4 AT F1/4+T10 L.400 |
| 5 | SR0807 | TUBO ZINCATO D10 SUPERIORE |
| 6 | SR0191 | ADATTATORE T 3 OGIVE D.10 |
| 7 | SR0112D | CILINDRO DI SOLLEVAMENTO DX |
| 8 | B93025 | RIDUZIONE 90 M1/4 M1/4 |
| 9 | SR0808 | TUBO ZINCATO D10 SUPERIORE |
| 10 | SR0275 | TUBO R2 1/4 AT F1/4+T10 L.450 |
| 11 | B92086 | COLLARE COMPLETO 2 TUBI D10-10 |
| 12 | SR0464 | PERNO FISSAGGIO CILINDRO |
| 13 | BZ92115 | COPIGLIA 6x60 UNI 1336 ZINCATO |
| 14 | S92010 | SNODO SFERICO SKF GE25ES M24x2A |

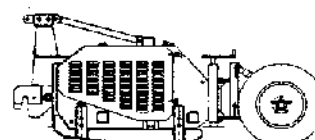
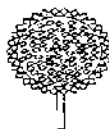

IMPIANTO IDRAULICO DI SOLLEVAMENTO

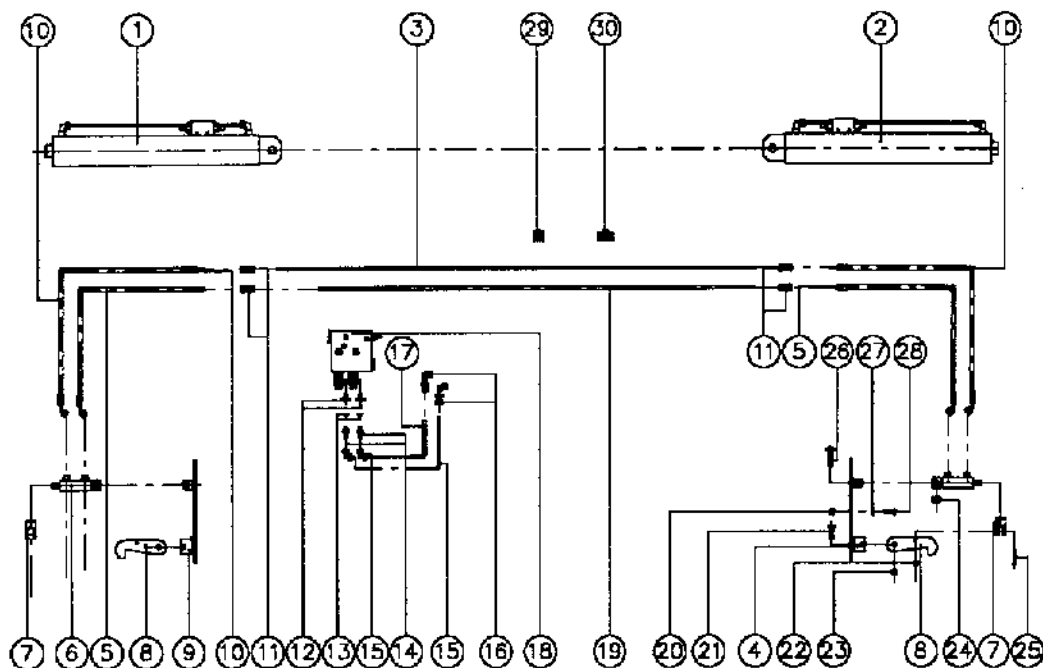

| POS. | CODICE | DESCRIZIONE |
|------|----------|--------------------------------|
| 1 | SR0112/S | CILINDRO DI SOLLEVAMENTO SX |
| 2 | SR0112/D | CILINDRO DI SOLLEVAMENTO DX |
| 3 | SR0561 | TUBO ZINCATO D10 L2170 |
| 4 | SR0430 | AGGANCIO PER CIL. BLOCC. DX |
| 5 | SR0505 | TUBO R2 AT L862 |
| 6 | SR0150 | CILINDRO DI BLOCCAGGIO |
| 7 | SR0398 | AGGANCIO PER CIL. DI BLOCC. |
| 8 | SR0456 | BECCO DI BLOCCAGGIO |
| 9 | SR0425 | AGGANCIO PER CIL. DI BLOCC. SX |
| 10 | SR0504 | TUBO R2 AT L1002 |
| 11 | SR0887 | RACC. DIRITTO TUBO D10 D10 |
| 12 | SR0651 | RIDUZIONE+GUARNIZ M 1/2 F 1/4 |
| 13 | SR0184 | RONDELLE IN RAME 1/4 |
| 14 | SR0174 | RIDUZIONE M 1/4 OGIVA 10 |
| 15 | B920103 | RACC. OLEOD. E 237 10L |
| 16 | B920102 | RACC. OLEOD. E 302 10L. |
| 17 | SR0809 | TUBO ZINC. D10 MASSELLO CORTO |
| 18 | SR0256 | BLOCCO VALVOLE IN ALLUMINIO |
| 19 | SR0560 | TUBO ZINCATO D10 L.2300 |
| 20 | B870013 | DADO M10 h=0,8 FLANG. TEMPR. |
| 21 | B92156 | VITE TSEI M12x45 UNI 5933 |
| 22 | B870019 | DADO M8 ALTO AUTOBLOCCANTE |
| 23 | B870028 | DADO M12 ALTO AUTOBLOCCANTE |
| 24 | B870059 | DADO M16 ALTO AUTOBLOCCANTE |
| 25 | B92035 | VITE TSEI M8x50 UNI 5933 |

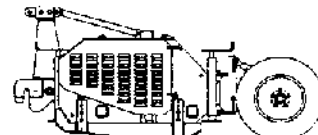
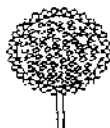

IMPIANTO IDRAULICO DI SOLLEVAMENTO

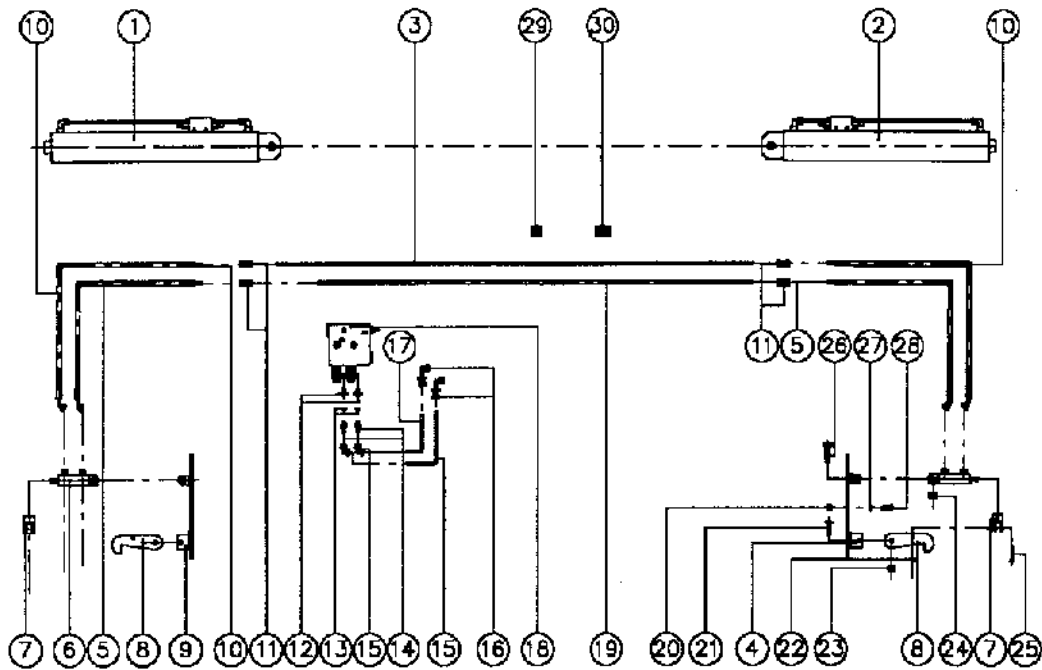

| POS. | CODICE | DESCRIZIONE |
|------|---------|--------------------------------|
| 26 | B870076 | VITE M16x55 UNI 5739 |
| 27 | B870017 | ROSETTA PER M10 UNI 6593 |
| 28 | B870067 | VITE M10x30 UNI 5739 |
| 29 | B92086 | COLLARE COMPLETO 2TUBI d.10-10 |
| 30 | B92087 | COLLARE COMPLETO 2TUBI d.15-15 |

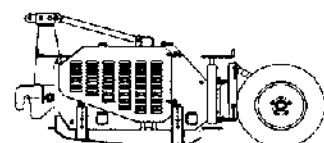
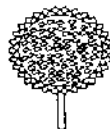
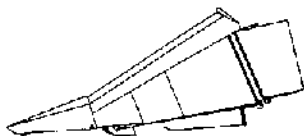

COCLEE IDRAULICHE LATERALIÀ

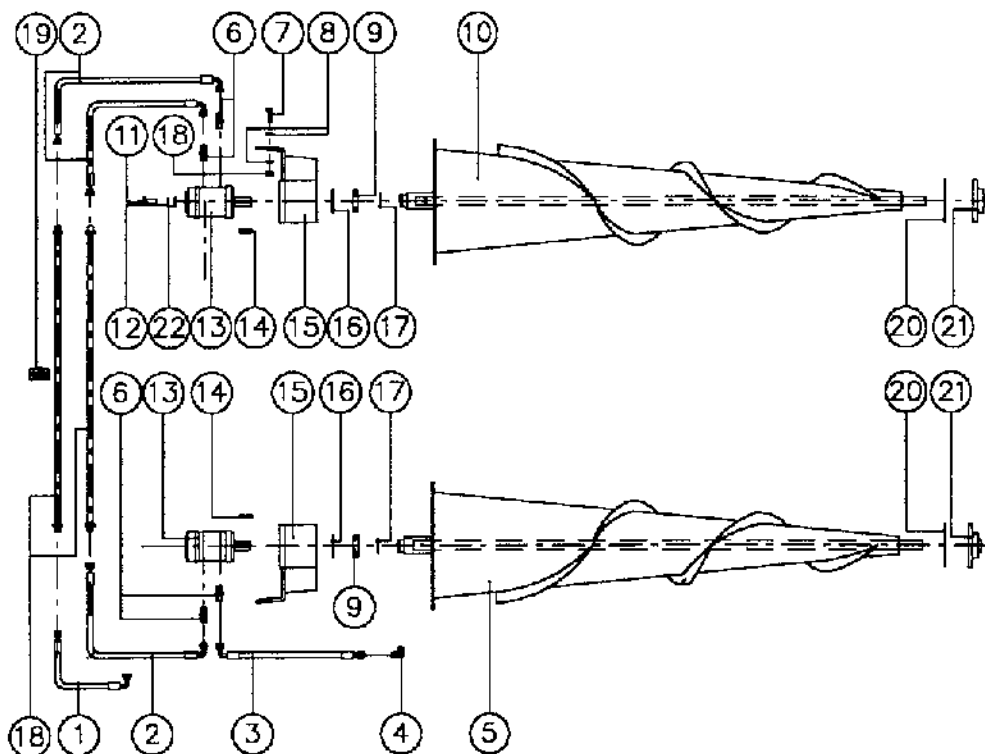

| POS. | CODICE | DESCRIZIONE |
|------|-------------|--------------------------------|
| 1 | SR0700 | TUBO DA FILTRO A T. DI RITORNO |
| 2 | SR0817 | TUBO DA MOTORE A TUBO IN FERRO |
| 3 | SR0701 | TUBO DEVIATORE MOTORE COCLEA |
| 4 | B93025 | NIPLES DI RIDUZIONE M1/4 M1/4 |
| 5 | SR0551 | COCLEA CONICA DX |
| 6 | B870225 | NIPLES DI CONGIUNZIONE 3/8 3/8 |
| 7 | BZ870032 | VITE M10x30 UNI 5739 ZINC. |
| 8 | BZ870011 | ROSETTA PER M10 ZINCATÀ |
| 9 | CL900001 | CUSCINETTO 6007-2RS |
| 10 | SR0400 | COCLEA CONICA SX |
| 11 | BZ870001 | VITE M12x30 UNI 5739 ZINC. |
| 12 | BZ870004 | R.D.E. PER M12 UNI 8842 ZINC. |
| 13 | CI880002 | MOTORE IDRAULICO OMP50 COCLEE |
| 14 | B870002 | LINGUETTA 8x7x30 UNI 6604-69A |
| 15 | SR0738 | SUPPORTO COCLEA LAT. MOD.1993 |
| 16 | B870116 | ANELLO ELAST. 162 UNI 7437-75 |
| 17 | B870238 | ANELLO ELAST. E35 UNI 7435-75 |
| 18 | SP87309/575 | TUBO IN Fe CON NIPLES SALDATO |
| 19 | B92087 | COLLARE COMPL. 2 TUBI d.15-15 |
| 20 | SP87308 | PROT. SUPP. ANT. COCLEA |
| 21 | S900001 | SUPPORTO UCFL BLOC. CON GRANO |
| 22 | BZ870035 | ROSETTA PER M12 UNI 6593 |



TRASM. POST. - TENDITORE CATENA -

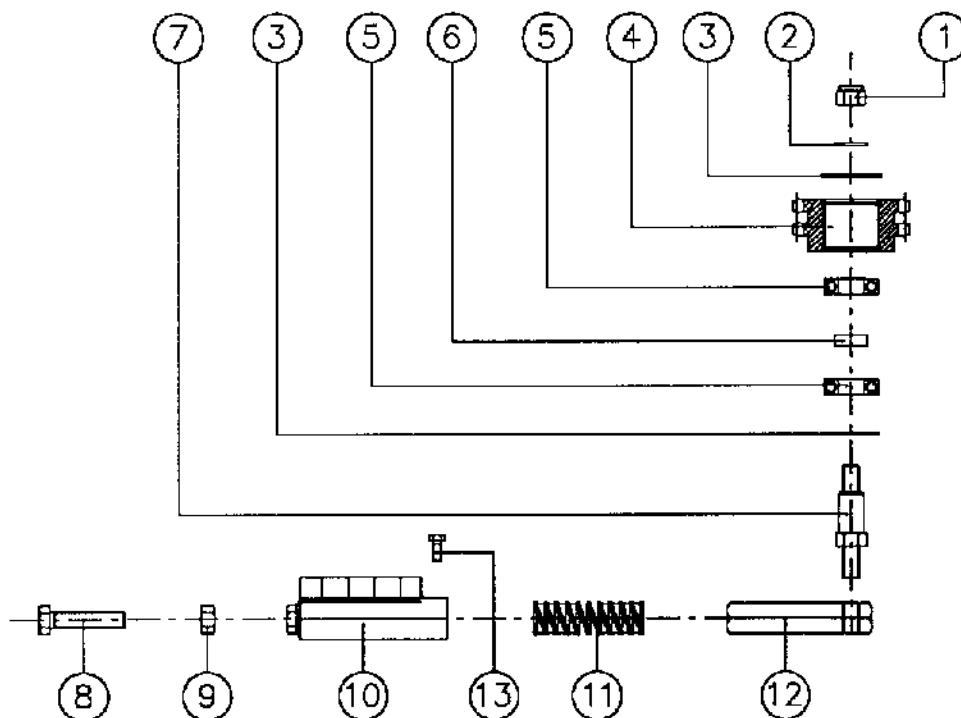

| POS. | CODICE | DESCRIZIONE |
|------|----------|-------------------------------|
| 1 | B870059 | DADO M16 ALTO AUTOBLOCCANTE |
| 2 | BZ870020 | ROSETTA PER M16 ZINCATA |
| 3 | B870065 | ANELLO ELAST. I52 UNI 7437-75 |
| 4 | SR0616 | PIGNONE Z17ASA60 DOPPIO |
| 5 | CU870010 | CUSCINETTO 6205-2RS |
| 6 | SR0617 | DISTANZIALE TENDITORE |
| 7 | SR0619 | ALBERINO PER TENDITORE |
| 8 | BZ870025 | VITE M16x70 UNI 7537 ZINCATA |
| 9 | BZ870027 | DADO M16 ALTO UNI 5587 |
| 10 | SR0615 | BLOCCO FISSO TENDITORE |
| 11 | SR0618 | MOLLA TENDITORE |
| 12 | SR0614 | PERNO ESAGONALE SCORREVOLE |
| 13 | BZ870030 | VITE M8x20 UNI 5739 ZINCATA |

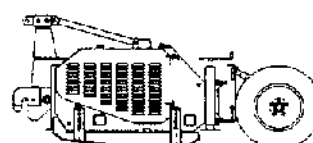
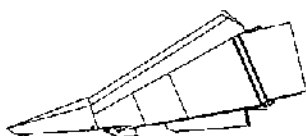

TRASM. POST. - SUPPORTO TRASM -ø

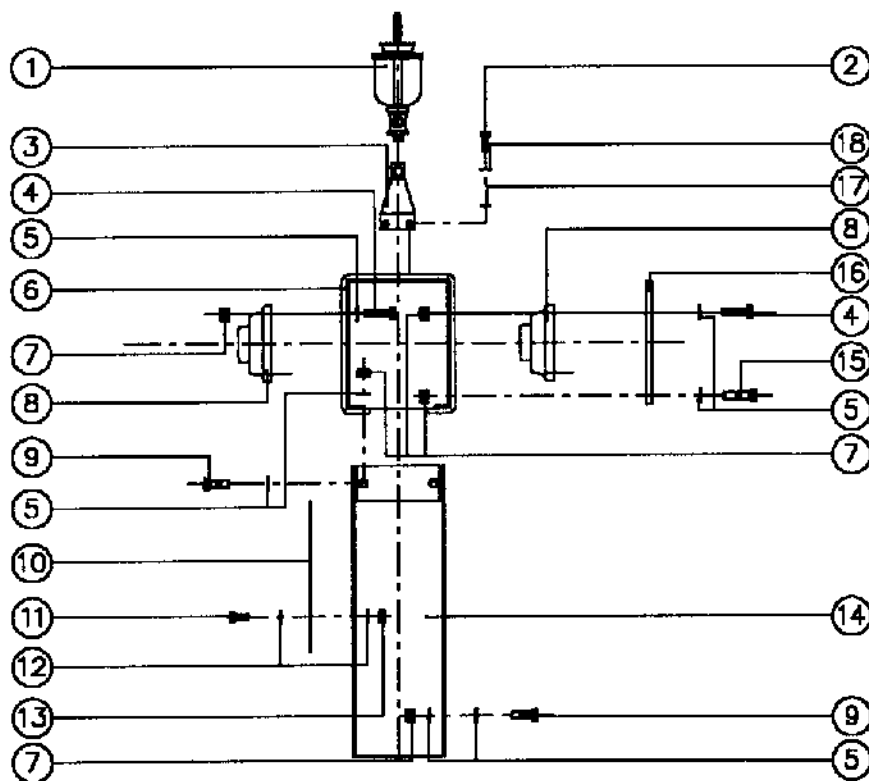

| POS. | CODICE | DESCRIZIONE |
|------|----------|---------------------------------|
| 1 | SR0722 | OLIATORE CATENA TRASMISSIONE |
| 2 | BZ870016 | VITE M8x25 UNI 5739 ZINCATA |
| 3 | SR0736 | SUPPORTO PER OLIATORE |
| 4 | BZ90007 | VITE M12x45 UNI 5739 ZINCATA |
| 5 | BZ870035 | ROSETTA PER M12 UNI 6593 ZINC. |
| 6 | SR0236 | SUPPORTO TRASMISSIONE SX |
| 6 | SR0294 | SUPPORTO TRASMISSIONE DX |
| 6 | SR0421 | SUPPORTO TRASMISSIONE SX LUNGO |
| 6 | SR0414 | SUPPORTO TRASMISSIONE DX LUNGO |
| 7 | B870028 | DADO M12 AL TO AUTOBLOCCANTE |
| 8 | S870002 | SUPPORTO UCF BLOCCAGGIO ECC. |
| 9 | BZ870002 | VITE M12x35 UNI 5739 ZINC. |
| 10 | SR0298 | LAMIERA CHIUSURA TRASMISSIONE |
| 10 | SR0423 | LAMIERA CHIUSURA TRASM. LUNGA |
| 11 | BZ870010 | VITE M10x25 UNI 5739 ZINCATA |
| 12 | BZ870007 | GREMBIAIINA 10x30x3 ZINCATA |
| 13 | B870013 | DADO M10 h=0.8 FLANG. TEMPR. |
| 14 | SR0295 | RINFORZO PER SUPP. TRASMISSIONE |
| 14 | SR0424 | RINFORZO PER SUPP. TRASM. LUNGO |
| 15 | BZ90001 | VITE M12x50 UNI 5737 ZINCATA |
| 16 | SR0299 | LAMIERA PER TRASM. N.H. FISSA |
| 17 | BZ870013 | ROSETTA PER M8 ZINCATA |
| 18 | BZ870014 | R.D.E. PER M8 UNI 8842 ZINC. |

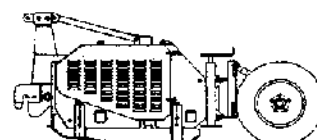
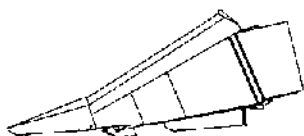

TRASMISSIONE POSTERIORE

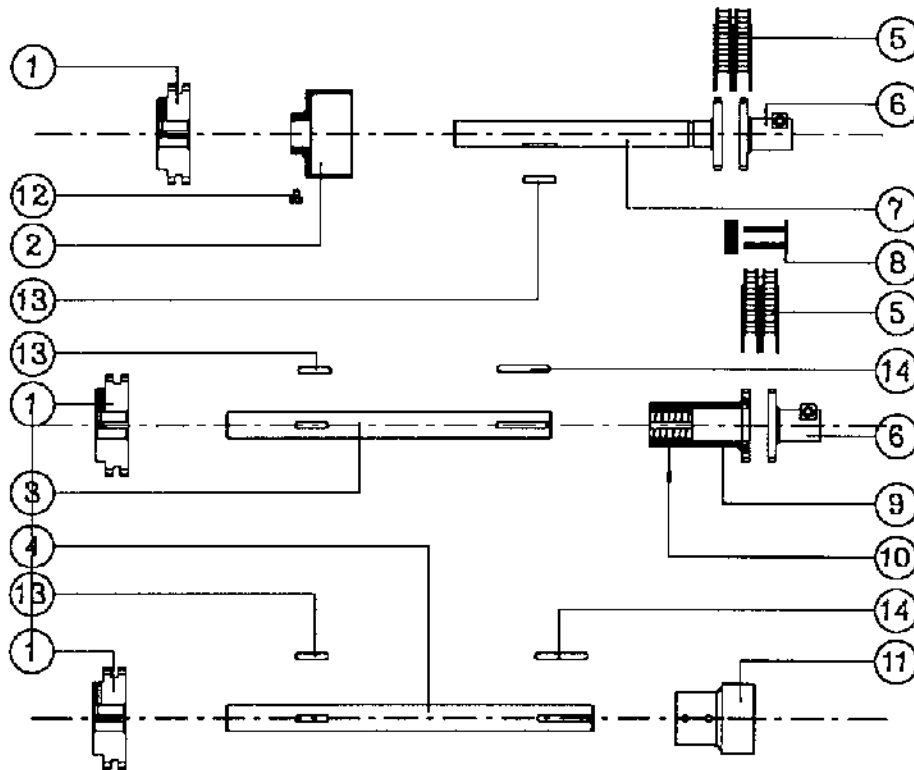

POS. CODICE DESCRIZIONE

| | | |
|---|--------|---------------------------------|
| 1 | SR0626 | PIGNONE Z24ASA60 DOPPIO F40 |
| 1 | SR0627 | PIGNONE Z15ASA60 DOPPIO |
| 1 | SR0628 | PIGNONE Z22ASA60 DOPPIO |
| 1 | SR0629 | PIGNONE Z19ASA60 DOPPIO |
| 2 | SR0767 | BUSSOLA PER TRASSMISS. CLASS PH |
| 3 | SR0761 | ALBERO TRASM. Dx I.H. 6x80 PH |
| 3 | SR0762 | ALBERO TRASM. Sx I.H. 6x80 PH |
| 3 | SR0632 | ALBERO TRASM. Dx I.H. |
| 3 | SR0633 | ALBERO TRASM. Sx I.H. |
| 3 | SR0605 | ALBERO TRASM. Tx 36 |
| 4 | SR0155 | ALBERO TRASM. N.H. |
| 4 | SR0750 | ALBERO TRASM. N.H. 6x70 |
| 5 | C92028 | CATENA ASA60 DOPPIA 11 PASSI |
| 6 | SR0607 | GINUTO CAT. 1"3/8 CON BOTTONE |
| 6 | SR0634 | GIUNTO CAT. 1"1/8 CON BOTTONE |
| 7 | SR0765 | ALB. Dx 6x75 CLASS PH L 455 |
| 7 | SR0766 | ALB. Sx 6x75 CLASS PH L 360 |
| 7 | SR0769 | ALB. Dx 6x80 CLASS PH L 435 |
| 7 | SR0770 | ALB. Sx 6x80 CLASS PH L 530 |
| 7 | SR0772 | ALB. Dx N.H. 6x75 L 407.5 |
| 7 | SR0774 | ALB. Sx N.H. 6x80 L 482.5 |
| 7 | SR0903 | ALB. Tx 36 L 357 |
| 7 | SR0915 | ALB. LAVERDA 624 L 345.5 |

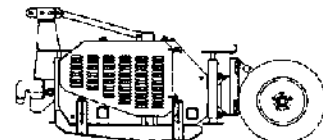

TRASMISSIONE POSTERIOREü

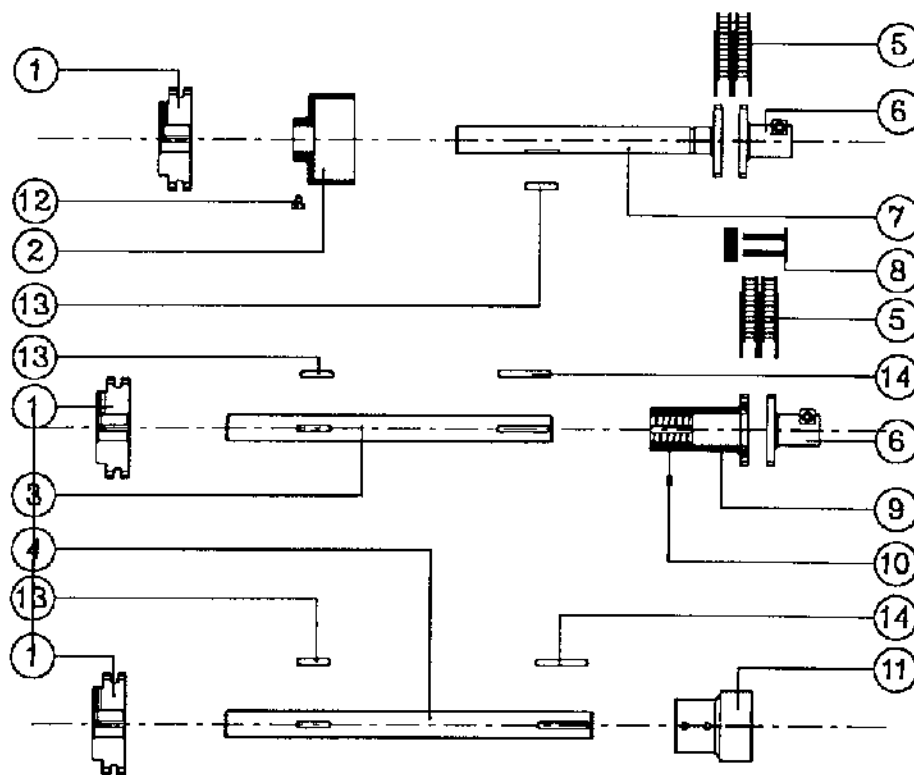

| POS. | CODICE | DESCRIZIONE |
|------|---------|-------------------------------|
| 8 | C92020 | GIUNTO CATENA ASA 80 DOPPIO |
| 9 | SR0606 | GIUNTO CATENA FORO 40 mm |
| 10 | B870092 | INGRASSATORE 1/8 GAS DIRITTO |
| 11 | GS87802 | GIUNTO N.H. IN GHISA |
| 12 | KA1214 | VITE CON BOMBATURA |
| 13 | B870056 | LINGUETTA 10x8x50 UNI6604-69A |
| 14 | B870057 | LINGUETTA 10x8x80 UNI6604-69A |

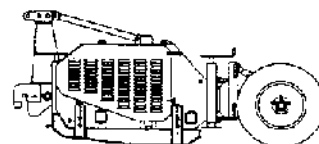
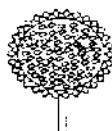

KIT MIX E TRASM. INFERIORE

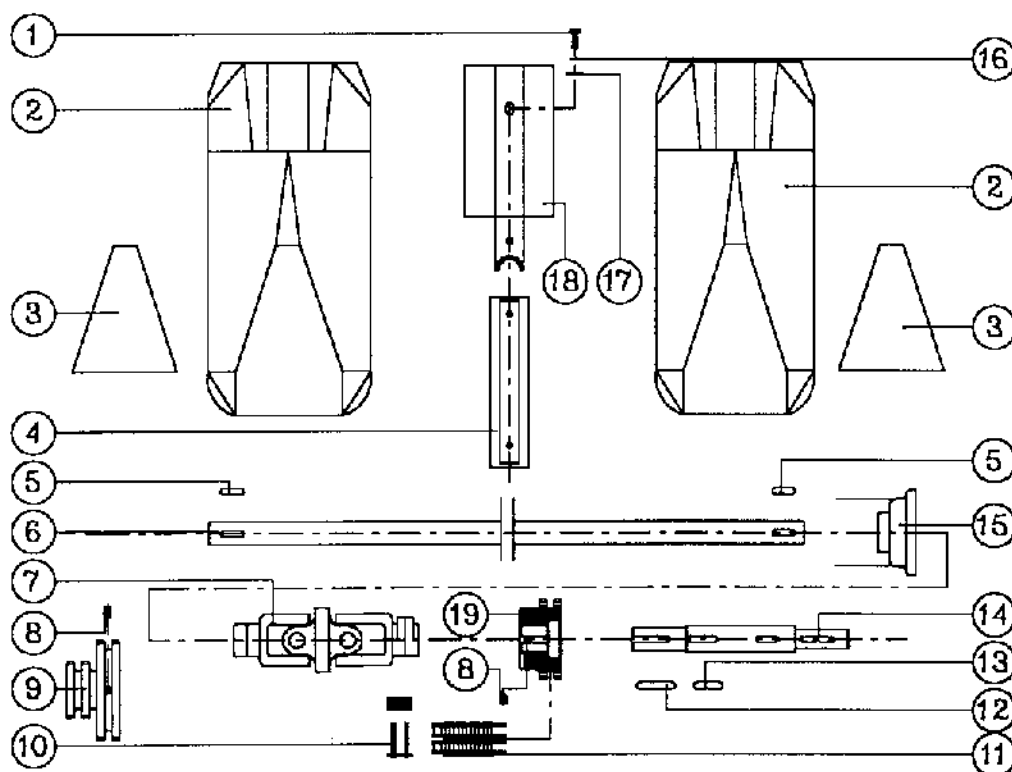

| POS. | CODICE | DESCRIZIONE |
|------|----------|--------------------------------|
| 1 | BZ870016 | VITE TE M8x25 UNI 5739 ZINC. |
| 2 | SR0798 | COFANA LAT.PUNT.RIB.DX R70 MIX |
| 2 | SR0581 | COFANO LAT.PUNT.RIB.DX R75 MIX |
| 2 | SR0541 | COFANO LAT.PUNT.RIB.DX R80 MIX |
| 2 | SR0799 | COFANO LAT.PUNT.RIB.SX R70 MIX |
| 2 | SR0823 | COFANO LAT.PUNT.RIB.SX R75 MIX |
| 2 | SR0648 | COFANO LAT.PUNT.RIB.SX R80 MIX |
| 3 | 90722/70 | COPERCHIO PER COFANO MIX R. 70 |
| 3 | 90722/75 | COPERCHIO PER COFANO MIX R. 75 |
| 3 | 90722/80 | COPERCHIO PER COFANO MIX R. 80 |
| 4 | 90723 | PIASTRA FISSAGGIO LAMA TAGLIO |
| 5 | B890002 | LINGUETTA 10x8x35 UNI 6604-69 |
| 6 | SR0230 | ALBERO PASSANTE PER 6x75 |
| 6 | SR0395 | ALBERO PASSANTE PER 6x80 |
| 7 | SP161849 | FORCELLA DOPPIA DIAMETRO 35mm |
| 8 | B92157 | GRANO A PUNTA M10x16 |
| 9 | SR0820 | PIGNONE Z13 Z24 ASA60 DOPPIO |
| 10 | C890008 | GIUNTO CATENA ASA 60 DOPPIO |
| 11 | C91003 | CATENA ASA 60 DOPPIO |
| 12 | B870056 | LINGUETTA 10x8x50 UNI 6604-69A |
| 13 | B870104 | LINGUETTA 10x8x45 UNI 6604-69 |
| 14 | SR0229 | ALBERO PER SCATOLA TRASMIS. |

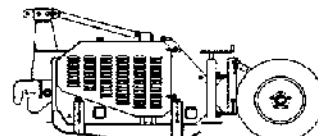
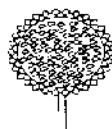

KIT MIX E TRASM. INFERIORE

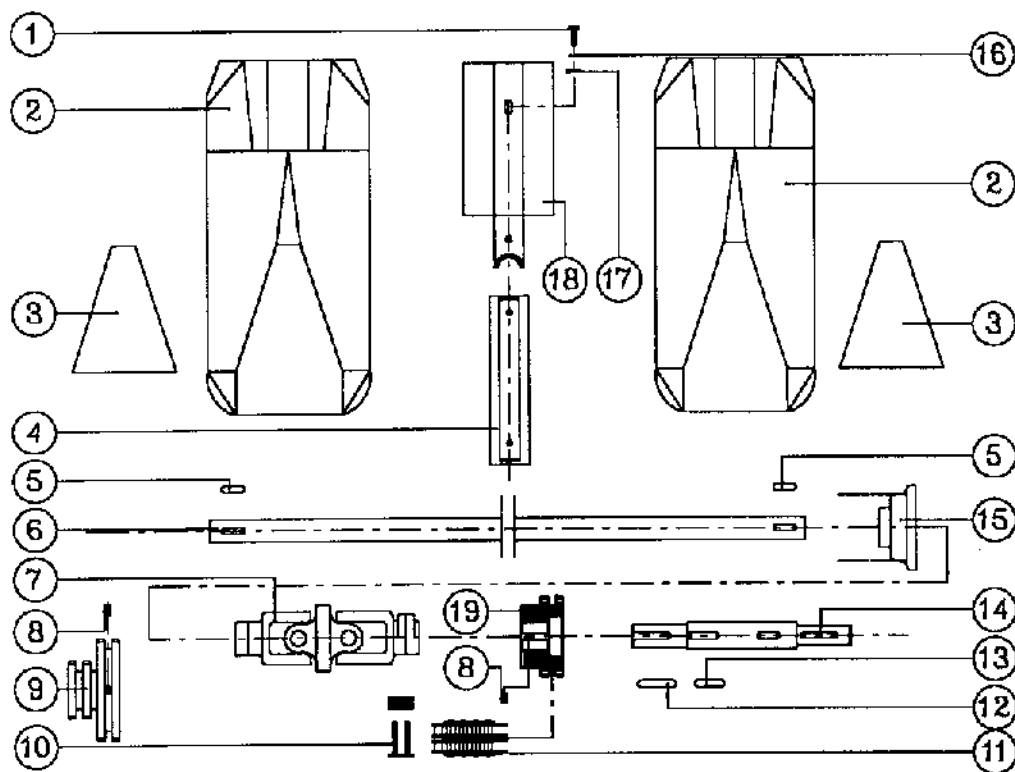

| POS. | CODICE | DESCRIZIONE |
|------|--------|-------------|
|------|--------|-------------|

| | | |
|----|----------|---------------------------------|
| 15 | S870002 | SUPPORTO UCF 208 D.40mm |
| 16 | BZ870014 | R.D.E. PER M8 UNI 8842 ZINC. |
| 17 | BZ870022 | GREMBIALINA 8x24 UNI16593 ZINC. |
| 18 | 90720 | LAMA DA TAGLIO CON PIEGHE |
| 19 | SR0625 | PIGNONE Z19 ASA 60 DOPPIO |

